



Flat 7 Hertford House

WATFORD, WD17 2QG

£1,250 Per Month

WHATS YOUR THOUGHT ON HERTFORD COURT! Take a look at this very modern and spacious 1 double bedroom modern apartment, this property is a commuters dream being only a 5 Minute walk from Watford Junction Station and only 20 Minutes into Euston.

The property offers a spacious open plan living with a study area and modern kitchen including all the white goods needed. The property also benefits from a spacious double bedroom and a modern shower room. DONT TAKE OUR WORD FOR IT COME VIEW TODAY.

Available Immediately

Viewing

Please contact our Watford Office on 01923224030 if you wish to arrange a viewing appointment for this property or require further information.

- Ground Floor Maisonette
- One Bedroom
- Large Reception
- Study Area
- Modern Fitted Kitchen
- Holding Deposit £288.00
- Council Tax Band B
- Double Glazed
- Central Location
- Recently Decorated



Floor Plan

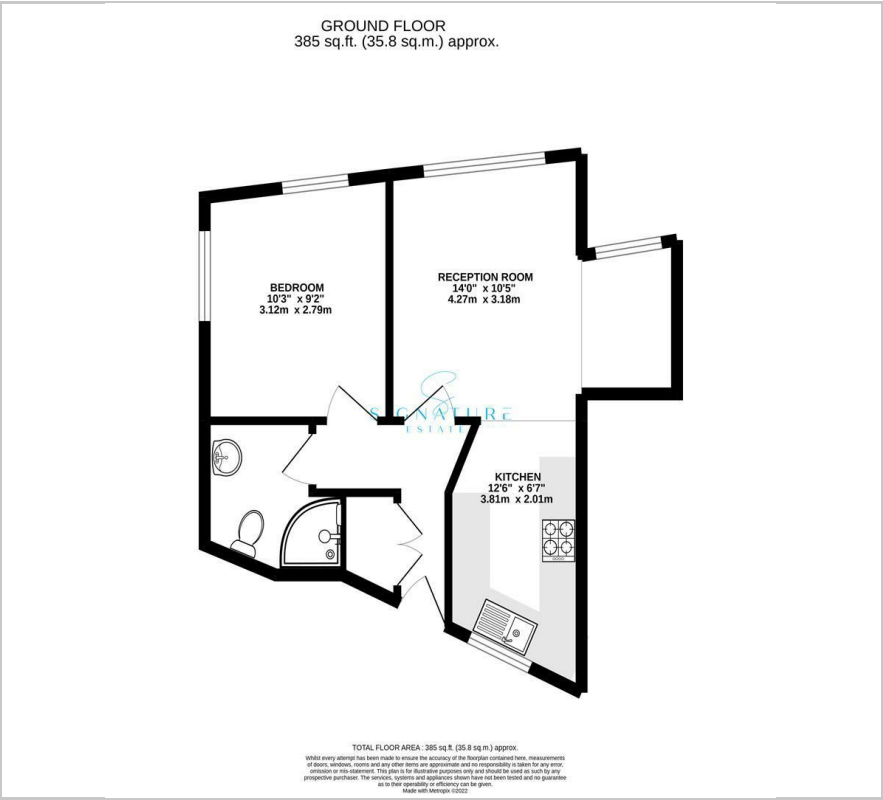

Area Map



Energy Efficiency Graph

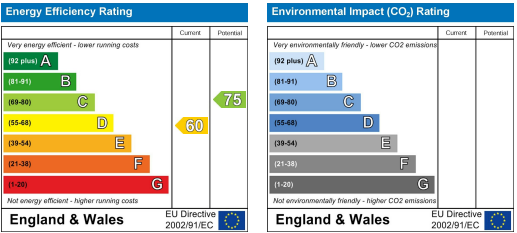

These particulars, whilst believed to be accurate are set out as a general outline only for guidance and do not constitute any part of an offer or contract. Intending purchasers should not rely on them as statements of representation of fact, but must satisfy themselves by inspection or otherwise as to their accuracy. No person in this firms employment has the authority to make or give any representation or warranty in respect of the property.