



1 Oakdene Road
WATFORD, WD24 6RN
Guide Price £575,000

Ideally positioned within a popular residential area, the property enjoys easy access to local amenities, well-regarded schools, and excellent transport connections, making it perfectly suited to both families and commuting professionals.

Combining spacious accommodation, flexible living areas, and exciting potential for personalisation, this impressive home presents a fantastic opportunity for buyers seeking a property in one of Watford's desirable locations. Early viewing is highly recommended.

Viewing

Please contact our Abbots Langley Office on 01923262666 if you wish to arrange a viewing appointment for this property or require further information.

- Extended Semi Detached Property
- Four Bedrooms
- Two Spacious Reception Rooms
- Two Bathrooms
- Outbuilding With Potential for Home Office/Gym Or Studio
- Large Open Plan Kitchen Diner
- Utility Area
- Off Street Parking
- Close To Local Amenities, Schools And Transport Links
- Viewing Highly Recommended



Floor Plan

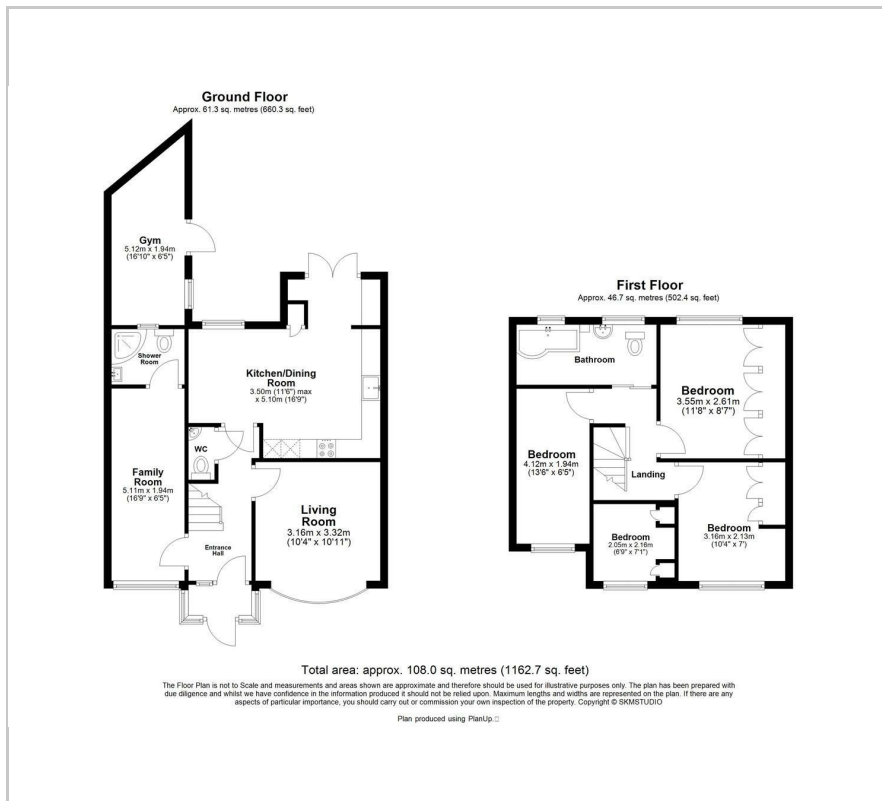

Area Map

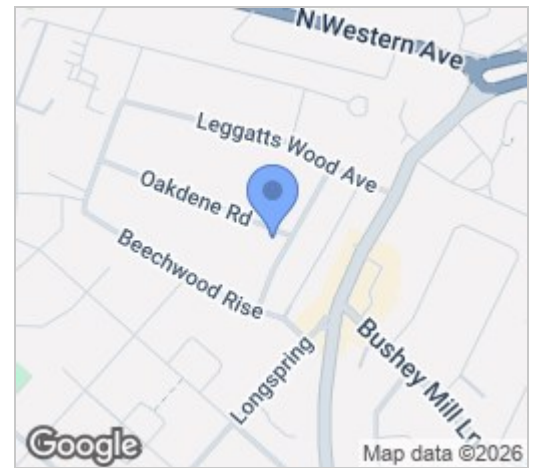

Energy Efficiency Graph

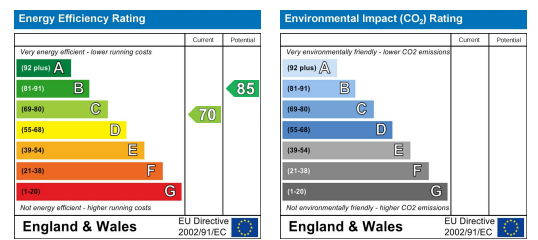

These particulars, whilst believed to be accurate are set out as a general outline only for guidance and do not constitute any part of an offer or contract. Intending purchasers should not rely on them as statements of representation of fact, but must satisfy themselves by inspection or otherwise as to their accuracy. No person in this firm's employment has the authority to make or give any representation or warranty in respect of the property.