



15 Widgeon Way

Watford, WD25 9UQ

Asking Price £525,000

Situated on Widgeon Way in the vibrant town of Watford, this delightful three-bedroom semi-detached family home presents an excellent opportunity for those seeking a comfortable and spacious living environment. The property boasts two well-proportioned reception rooms, providing ample space for both relaxation and entertaining.

The three bedrooms are thoughtfully designed, offering a peaceful retreat for family members. The bathroom is conveniently located to serve the needs of the household. One of the standout features of this home is the large garage, equipped with an electric up and over door, which adds to the convenience of daily life. Additionally, the driveway allows parking for up to three vehicles, making it ideal for families with multiple cars.

The attractive rear garden is a perfect outdoor space for children to play or for hosting summer gatherings with friends and family. This property is offered with no upper chain, ensuring a smooth transition for the new owners.

Viewing

Please contact our Abbots Langley Office on 01923262666 if you wish to arrange a viewing appointment for this property or require further information.

- Semi Detached Family Home
- Three Bedrooms
- Lounge/Dining Room
- Large Garage With Electric Up And Over Door
- Driveway
- Popular Family Area
- No Upper Chain
- Viewings By Appointment Only



Floor Plan

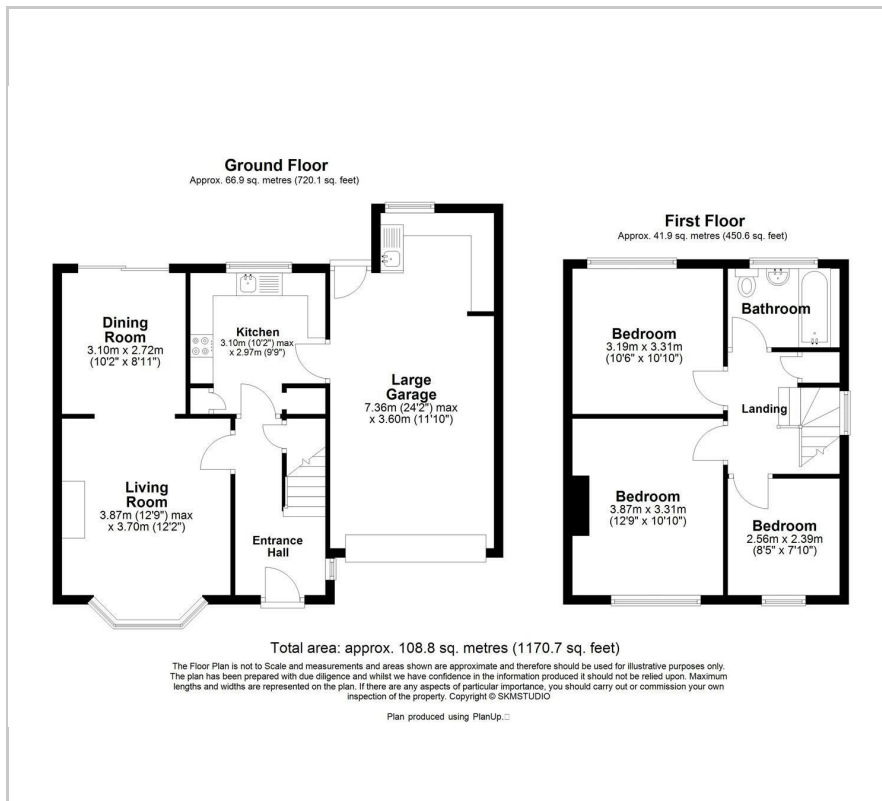

Area Map



Energy Efficiency Graph

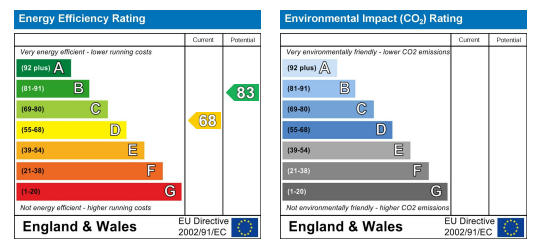

These particulars, whilst believed to be accurate are set out as a general outline only for guidance and do not constitute any part of an offer or contract. Intending purchasers should not rely on them as statements of representation of fact, but must satisfy themselves by inspection or otherwise as to their accuracy. No person in this firm's employment has the authority to make or give any representation or warranty in respect of the property.