



WV WESTWOODLEBER

**WV WESTWOODLEBER**  
LET US GUIDE YOU HOME

Amwell Street, Hoddesdon, EN11 8UA  
£250,000

Amwell Street, Hoddesdon, EN11 8UA

Westwood Leber is delighted to present this two-bedroom apartment, located just off Hoddesdon High street.



WL WESTWOODLEBER



Ground Floor

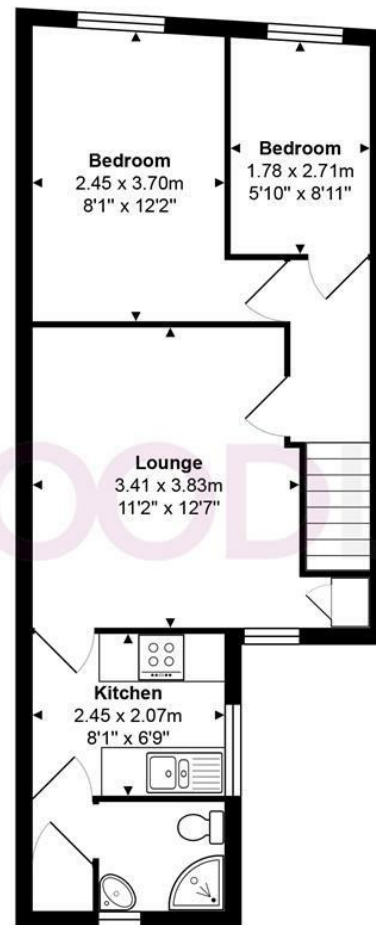

First Floor

Total Area: approx. 44.9 m<sup>2</sup> ... 484 ft<sup>2</sup>

THE FLOORPLAN IS FOR ILLUSTRATIVE PURPOSES ONLY AND IS NOT TO SCALE.  
Measurements and features are approximate and may differ from the actual property. Verify all details independently; no liability is accepted for errors or omissions.

Property marketing provided by [www.fotomarketing.co.uk](http://www.fotomarketing.co.uk)









