



WESTWOODLEBER

WESTWOODLEBER
LET US GUIDE YOU HOME

Tovey Avenue, Hoddesdon, EN11 9EL
Offers in excess of £475,000



Tovey Avenue, Hoddesdon, EN11 9EL

Westwood Leber are delighted to bring to the market this well-presented three-bedroom semi-detached family home, ideally situated on the sought-after Tovey Avenue in Hoddesdon.

Offering spacious and well-arranged accommodation throughout, the property comprises a welcoming entrance hall leading into a bright and airy living room, perfect for both relaxing and entertaining. To the rear, a well-appointed kitchen flows seamlessly into a dining area, creating an excellent space for family living and hosting guests, with direct access onto the garden.

The first floor boasts three bedrooms, including two generous doubles and a further well-proportioned single, all served by a modern family bathroom.

Externally, the property benefits from a good-sized rear garden, ideal for outdoor dining and leisure. To the front, there is a driveway providing off-street parking, while to the rear you will find a garage, conveniently accessed via side access.

Ideally positioned within close proximity to Rye House railway station, offering direct links into London Liverpool Street, as well as being within easy reach of Hoddesdon town centre, local schools and amenities, this attractive home would make an ideal purchase for families and commuters alike. A internal viewing is highly recommended!



 WESTWOODLEBER

 WESTWOODLEBER
LET US GUIDE YOU HOME

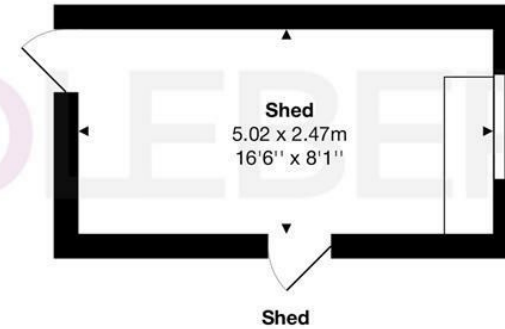
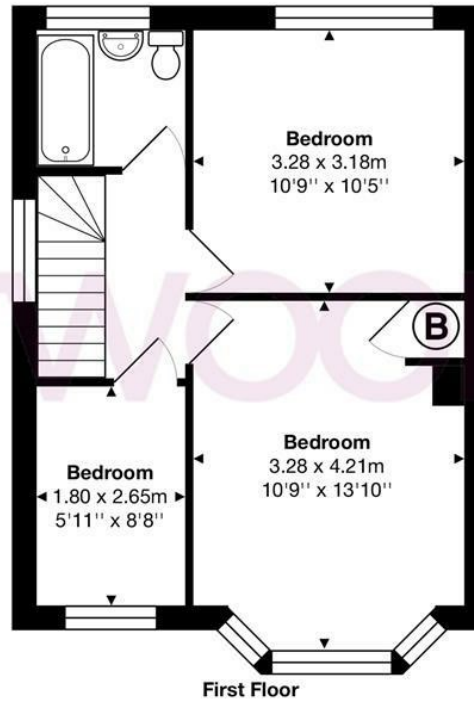
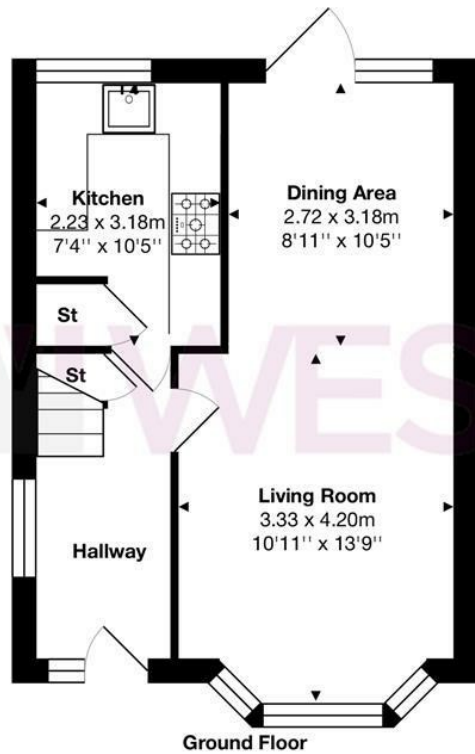

Total Area: approx. 85.7 m² ... 922 ft²

THE FLOORPLAN IS FOR ILLUSTRATIVE PURPOSES ONLY AND IS NOT TO SCALE.
 Measurements and features are approximate and may differ from the actual property. Verify all details independently; no liability is accepted for errors or omissions.

Property marketing provided by www.fotomarketing.co.uk





WESTWOODLEBER



WESTWOODLEBER



WESTWOODLEBER



WESTWOODLEBER



WESTWOODLEBER



WESTWOODLEBER



WESTWOODLEBER



WESTWOODLEBER



WESTWOODLEBER



WESTWOODLEBER



WESTWOODLEBER



WESTWOODLEBER





