



WESTWOODLEBER

WESTWOODLEBER
LET US GUIDE YOU HOME

Roundhills, Waltham Abbey, EN9 1UN
Offers in excess of £475,000



Roundhills, Waltham Abbey, EN9 1UN

Westwood Leber is thrilled to present to the market this newly refurbished three bedroom semi-detached family home, ideally situated in a highly sought-after location in Waltham Abbey. This exceptional property features an open-plan kitchen/diner equipped with brand-new appliances, complemented by double doors that lead to a beautifully landscaped rear garden. Additionally, the home boasts a spacious separate lounge, a convenient downstairs w/c, and three generously sized bedrooms along with a stylish three-piece bathroom suite.

Further advantages include a spacious front driveway and a garage, and the property is offered chain-free. We highly recommend an internal viewing to appreciate all that this lovely home has to offer!



 WESTWOODLEBER

 WESTWOODLEBER
LET US GUIDE YOU HOME

Ground Floor

Approx. 49.9 sq. metres (537.3 sq. feet)



First Floor

Approx. 34.3 sq. metres (369.2 sq. feet)

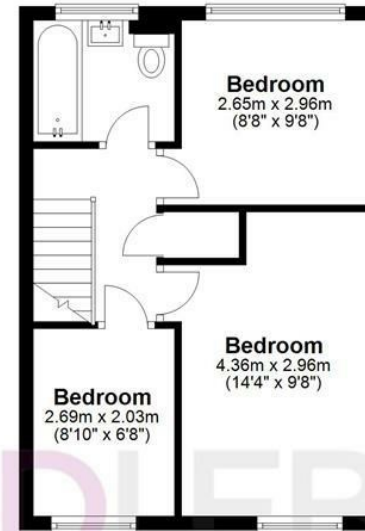

Total area: approx. 84.2 sq. metres (906.5 sq. feet)

THE FLOORPLAN IS FOR ILLUSTRATIVE PURPOSES ONLY AND IS NOT TO SCALE. Measurements and features are approximate and may differ from the actual property. Verify all details independently; no liability is accepted for errors or omissions.

[Property marketing provided by www.fotomarketing.co.uk](http://www.fotomarketing.co.uk)



WESTWOODLEBER



WESTWOODLEBER



WESTWOODLEBER



WESTWOODLEBER









 WESTWOODLEBER

 WESTWOODLEBER
LET US GUIDE YOU HOME