

## Bentley Road, Hertford, SG14 2HE

Westwood Leber are delighted to bring to the market this spacious and well-presented three-bedroom maisonette, ideally located on Bentley Road in Hertford. Offering generous accommodation across two floors, this impressive home is perfectly suited to first-time buyers, families or investors alike.

The property comprises a welcoming entrance porch and hallway leading into a bright and sizeable living room, ideal for both relaxing and entertaining. To the rear, a well-appointed kitchen flows seamlessly into a dedicated dining area, creating a practical and sociable layout for modern living.

Upstairs, the property benefits from three well-proportioned bedrooms, including a generous principal bedroom, alongside a contemporary wet room, all presented in good condition throughout.

Externally, this home continues to impress with a substantial outbuilding, complete with power, offering excellent versatility as a home office, gym or workshop. The property also benefits from a private driveway, providing convenient off-street parking.

Situated within easy reach of Hertford town centre, local amenities, schooling and excellent transport links, this fantastic maisonette offers both space and convenience in a sought-after location. An internal viewing is highly recommended.



**WESTWOODLEBER**

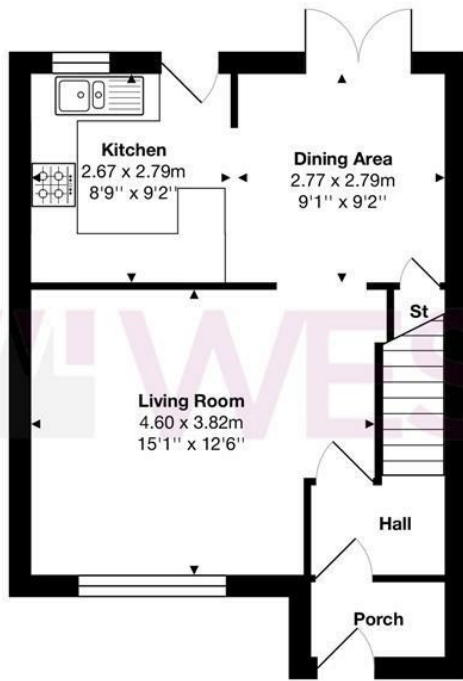

Ground Floor

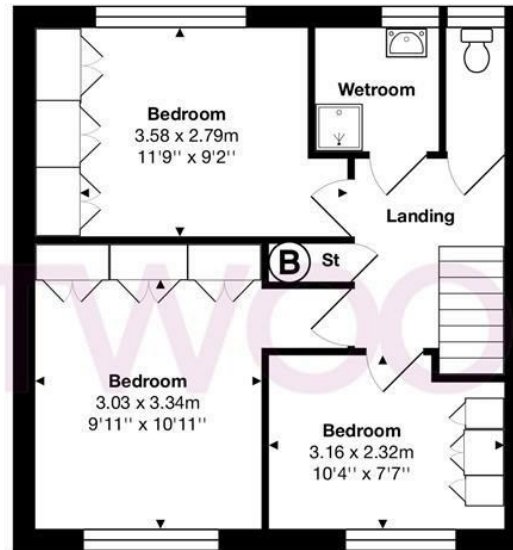

First Floor

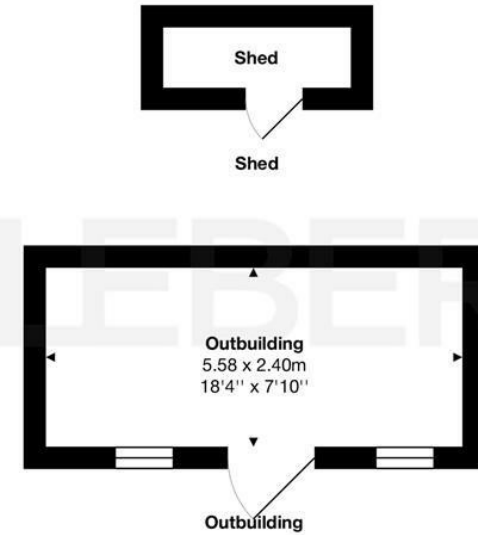

Total Area: approx. 96.7 m<sup>2</sup> ... 1041 ft<sup>2</sup>

THE FLOORPLAN IS FOR ILLUSTRATIVE PURPOSES ONLY AND IS NOT TO SCALE.  
 Measurements and features are approximate and may differ from the actual property. Verify all details independently; no liability is accepted for errors or omissions.

Property marketing provided by [www.fotomarketing.co.uk](http://www.fotomarketing.co.uk)







WESTWOODLEBER



WESTWOODLEBER



WESTWOODLEBER



WESTWOODLEBER





