







## Berners Way, Broxbourne, EN10 6NL

Westwood Leber are delighted to bring to the market this beautifully presented one-bedroom apartment situated within the highly sought-after Marley Court development in Broxbourne.

This stylish home offers bright and well-proportioned accommodation throughout, featuring a spacious open-plan lounge and dining area that provides the perfect setting for relaxing or entertaining. The modern fitted kitchen is equipped with contemporary units and excellent storage space, complementing the clean, neutral décor throughout the property. The bedroom is generously sized and benefits from built-in wardrobes, while the bathroom has been finished to a high standard with modern fixtures and fittings.

Externally, the apartment is positioned within a well-maintained development offering allocated residents' parking, additional visitor parking, and attractive communal grounds.

Ideally located close to Broxbourne Station, the property provides excellent transport links into London and easy access to local shops, restaurants, and green open spaces. An internal viewing is highly recommended to fully appreciate the quality and convenience of this impressive home.





 WESTWOODLEBER

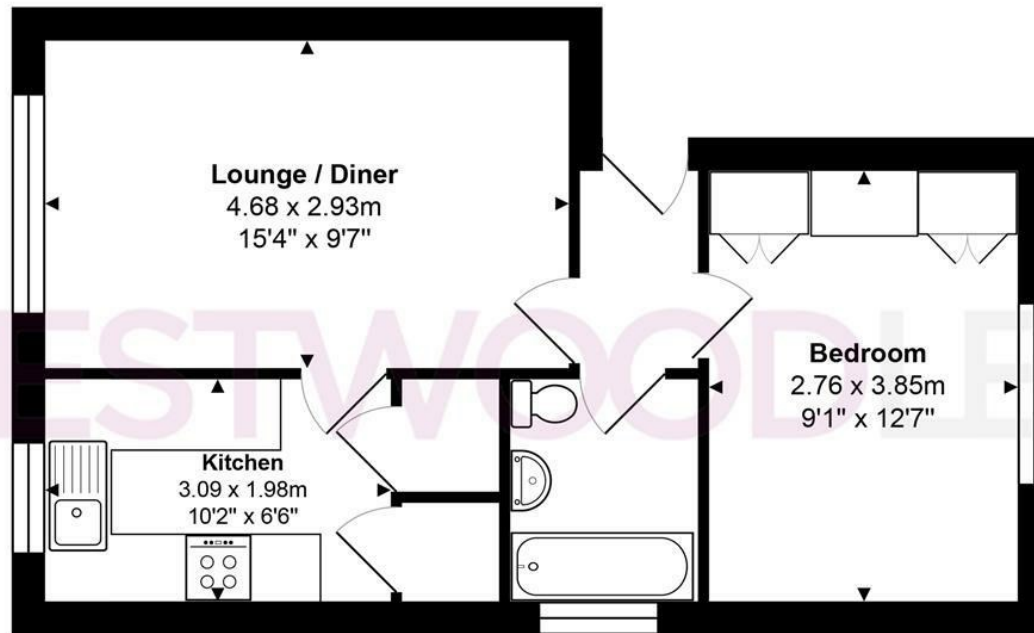

Total Area: approx. 38.9 m<sup>2</sup> ... 419 ft<sup>2</sup>

THE FLOORPLAN IS FOR ILLUSTRATIVE PURPOSES ONLY AND IS NOT TO SCALE.  
Measurements and features are approximate and may differ from the actual property. Verify all details independently; no liability is accepted for errors or omissions.

Property marketing provided by [www.fotomarketing.co.uk](http://www.fotomarketing.co.uk)







