





High Wood Road, Hoddesdon, EN11 9AP

Westwood Leber are delighted to bring to the market this well-presented two-bedroom end of terrace family home, ideally positioned on the popular High Wood Road in Hoddesdon.

This charming property offers bright and spacious accommodation throughout, comprising a welcoming entrance hallway, a ground floor cloakroom, a generous lounge, and a modern kitchen/dining area with direct access to the rear garden — perfect for entertaining and family living.

On the first floor, there are two well-proportioned bedrooms, a versatile nursery or home office, and a stylish family bathroom. The home further benefits from a boarded loft room, providing an excellent additional space ideal for storage or a hobby area.

Externally, the property boasts a private rear garden and a single garage located directly behind the home, offering both parking and additional storage convenience.

Situated within easy reach of Hoddesdon town centre, excellent local schools, and transport links including Broxbourne and Rye House stations with direct access into London, this home makes an ideal purchase for first-time buyers, young families, or downsizers alike. An early internal viewing is highly recommended!



WESTWOODLEBER

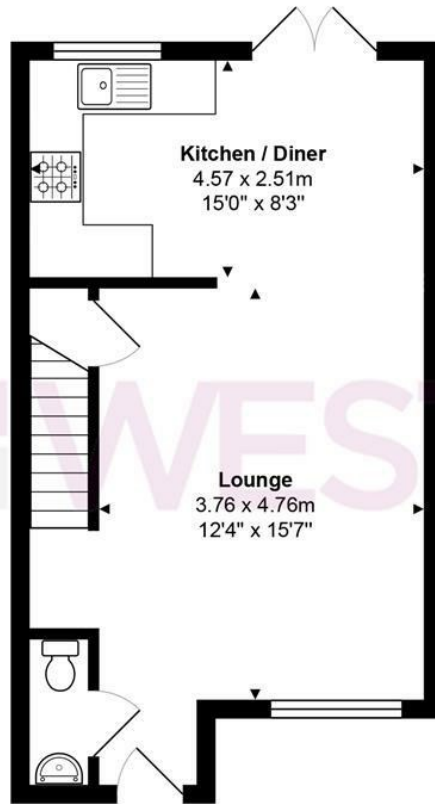

Ground Floor

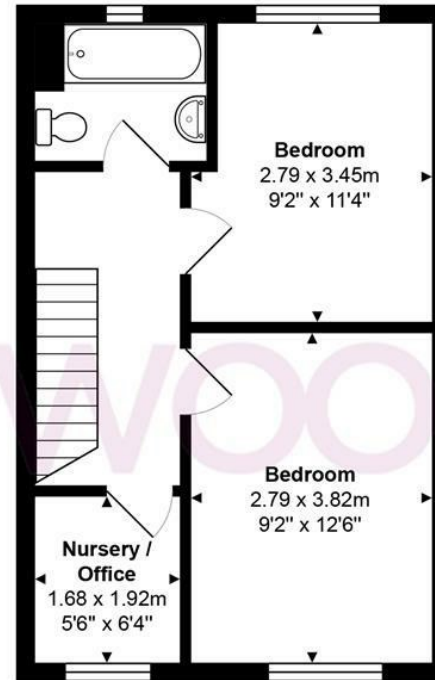

First Floor

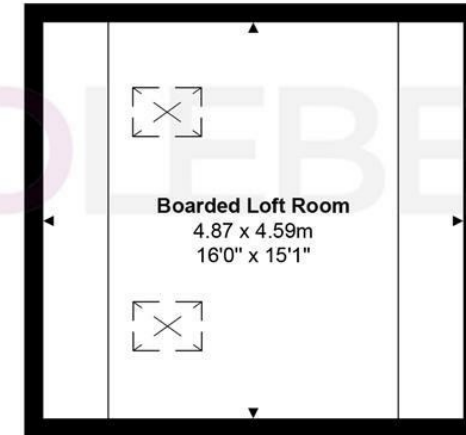

Loft Room

Total Area: approx. 92.1 m² ... 991 ft²

THE FLOORPLAN IS FOR ILLUSTRATIVE PURPOSES ONLY AND IS NOT TO SCALE.
Measurements and features are approximate and may differ from the actual property. Verify all details independently; no liability is accepted for errors or omissions.

Property marketing provided by www.fotomarketing.co.uk











WESTWOODLEBER