





Dobbs Weir Road, Roydon, Harlow, CM19 5JX

**** DEVELOPMENT OPPORTUNITY FOR CASH BUYERS ONLY **** Westwood Leber are pleased to bring to the market this rarely available detached bungalow, set on a substantial plot in the highly desirable area of Dobbs Weir.

Offering tremendous scope for development (STPP), this property presents an exciting opportunity—whether you're an investor looking to unlock its full potential or a buyer eager to create a bespoke dream home in a fantastic location.

This is a unique chance to secure a versatile property in a peaceful yet well-connected setting.

Viewings are available by appointment only—contact us today to arrange yours.



WESTWOODLEBER

Outbuilding

Approx. 38.5 sq. metres (414.2 sq. feet)

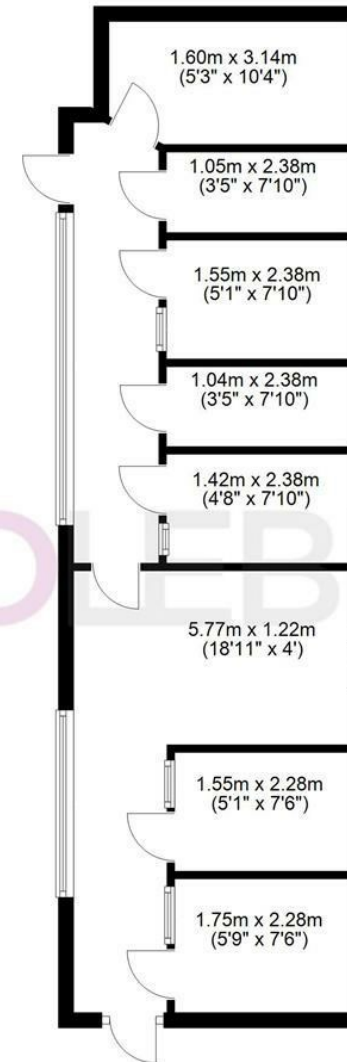

Ground Floor

Approx. 51.5 sq. metres (554.8 sq. feet)



Total area: approx. 90.0 sq. metres (969.1 sq. feet)

THE FLOORPLAN IS FOR ILLUSTRATIVE PURPOSES ONLY AND IS NOT TO SCALE. Measurements and features are approximate and may differ from the actual property. Verify all details independently; no liability is accepted for errors or omissions.

Property marketing provided by www.fotomarketing.co.uk





