



31 Cornton Place, Crieff, PH7 3AP
Offers over £85,000





31 Cornton Place Crieff, PH7 3AP

Offers over £85,000

- Stylish one-bedroom house
- Modern fitted kitchen
- Generous double bedroom
- Vaulted ceilings and Velux windows
- Double glazing
- Spacious open-plan living area
- Contemporary shower room
- Fitted wardrobe storage
- Gas central heating
- Central Crieff location

Situated in a convenient central location within the popular market town of Crieff, this stylish one-bedroom house offers modern, low-maintenance living across two levels and is presented in excellent move-in condition throughout.

Accessed via a private entrance, the accommodation begins on the ground floor with a welcoming hallway, a generous double bedroom complete with fitted wardrobe storage, and a contemporary shower room featuring a modern suite and attractive tiled finish. A staircase leads to the impressive upper level, where the property truly comes into its own. The bright and spacious open-plan living, dining and kitchen area provides a fantastic modern living environment, enhanced by vaulted ceilings and multiple Velux windows which flood the space with natural light. The well-appointed kitchen is fitted with a range of contemporary units and integrated appliances, while the flexible layout allows ample room for both lounge and dining furniture. The property has been tastefully decorated in neutral tones throughout, creating a fresh and inviting atmosphere that will appeal to a wide range of buyers. Double glazing and gas central heating ensure year-round comfort and efficiency. Ideal for first-time buyers, professionals, downsizers or investors seeking a ready-to-let opportunity, this unique home combines character with modern practicality. Its central position places shops, cafés, restaurants and local amenities within easy walking distance, while excellent transport links provide convenient access to Perth, Stirling and beyond. A fantastic opportunity to acquire a well-presented home in one of Perthshire's most desirable towns.





Location

Crieff is a vibrant and historic market town situated in the heart of Perthshire, renowned for its attractive streetscapes, independent shops, cafés and restaurants. The town offers an excellent range of everyday amenities, including supermarkets, leisure facilities, healthcare services and highly regarded schooling. Surrounded by beautiful countryside, Crieff provides easy access to walking, cycling and outdoor pursuits, while nearby attractions include golf courses, fishing and the renowned Glenturret Distillery. Excellent road links connect the town to Perth, Stirling, Dundee and Edinburgh, making it an attractive base for commuters while retaining the charm and character of a traditional Scottish town.



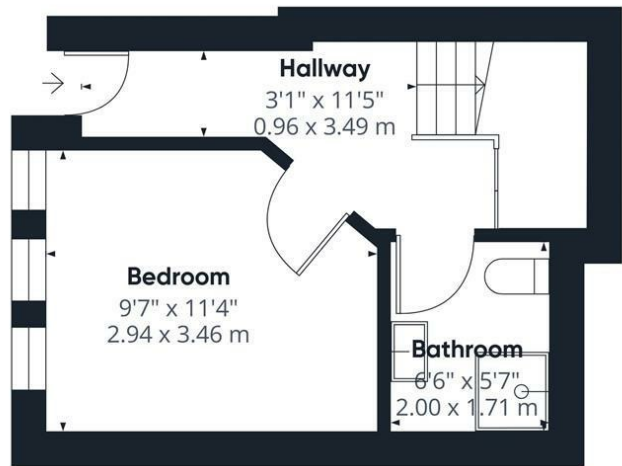

Ground floor



Floor 1



Approximate total area⁽¹⁾

480 ft²
44.6 m²

Reduced headroom

26 ft²
2.4 m²

(1) Excluding balconies and terraces.

Reduced headroom
----- Below 5 ft/1.5 m

Calculations reference the RICS IPMS 3C standard. Measurements are approximate and not to scale. This floor plan is intended for illustration only.

GIRAFFE 360

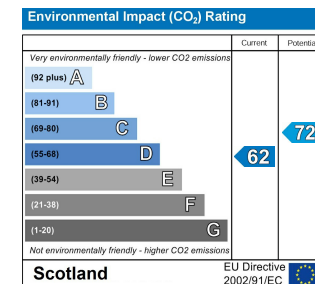
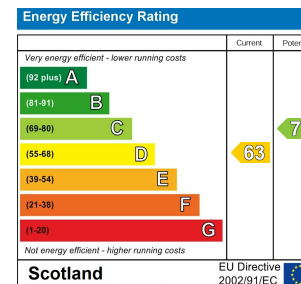
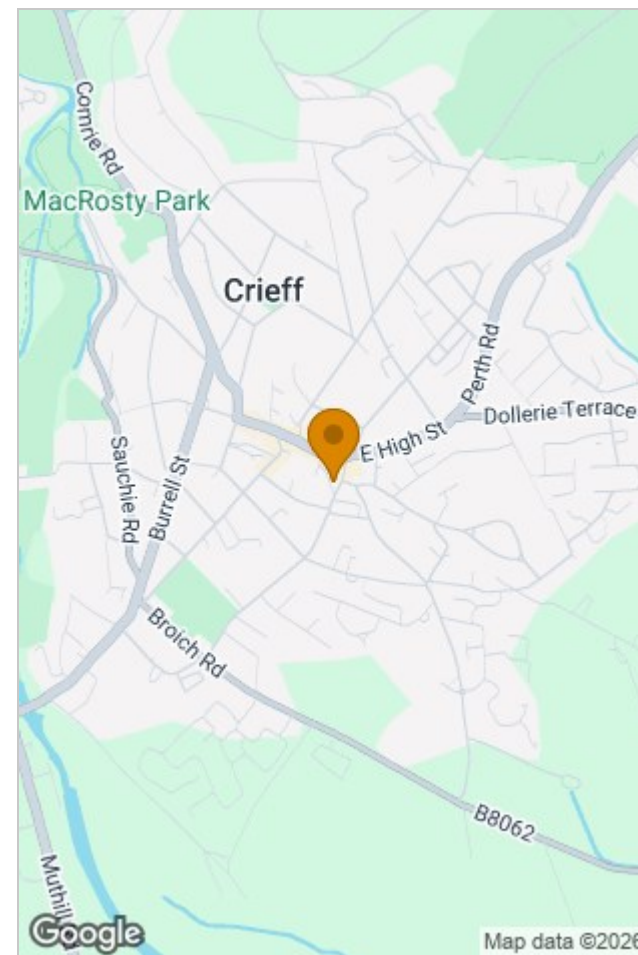

Viewing

Please contact our Perth Office on 01738 260 035

if you wish to arrange a viewing appointment for this property or require further information.

The particulars are set out as a general outline only for the guidance of intended purchasers or lessees, and do not constitute, any part of a contract. Nothing in these particulars shall be deemed to be a statement that the property is in good structural condition or otherwise nor that any of the services, appliances, equipment or facilities are in good working order. Purchasers should satisfy themselves of this prior to purchasing.

Inveralmond Business Centre 6 Auld Bond Road, Perth, Perthshire, PH1 3FX

T. 01738 260 035 | hello@wearepossible.co.uk

wearepossible.co.uk

