



299 Primrose Crescent, Perth, PH1 2QT
Offers over £130,000

 2  1  1  C



299 Primrose Crescent Perth, PH1 2QT

- Well-presented 2-bedroom mid-terrace home
- Stylish fitted kitchen with garden access
- Two generously sized bedrooms with storage
- Gas central heating and double glazing
- Quiet residential location in Tulloch
- Bright lounge with modern décor
- Updated bathroom with full-height tiling
- Fully enclosed rear garden with patio and lawn
- On-street parking available
- Close to shops, schools and transport links

Set in the sought-after Tulloch area of Perth, 299 Primrose Crescent is a beautifully presented two-bedroom mid-terrace home, ideal for first-time buyers, young professionals or downsizers. Offering stylish interiors and a practical layout, the property blends comfort with convenience across two well-appointed levels.

On the ground floor, a welcoming entrance hallway opens into a bright and spacious lounge with large windows and tasteful décor. The fitted kitchen sits to the rear, featuring contemporary units, integrated appliances, and direct access to the enclosed rear garden—ideal for summer dining or entertaining. Upstairs, the home offers two well-proportioned bedrooms, both finished in soft, neutral tones with excellent storage solutions. The family bathroom boasts elegant full-height tiling, a modern suite, and a shower-over-bath. Externally, the front garden is low-maintenance and neatly presented, while the rear garden provides a fully enclosed, private space laid mainly to lawn with a patio area. On-street parking is available directly outside the property. Further benefits include gas central heating, double glazing throughout, and a location that's well connected to local amenities. Tulloch offers nearby schools, shops, bus routes and excellent access to Perth city centre and the A9. A lovely, move-in ready home in a family-friendly area—ideal for those looking to take their next step.

Offers over £130,000





Location

Tulloch is a popular and well-established area in northwest Perth, offering a peaceful yet convenient lifestyle. Known for its community feel, Tulloch is particularly attractive to first-time buyers, families and retirees. Local amenities include shops, primary schools, bus routes, and access to Perth College UHI. For commuters, the A9 and city centre are within easy reach. There are also green spaces nearby for walking and play. With a blend of affordability, strong local services, and excellent transport links, Tulloch continues to be a desirable area for buyers seeking a well-connected home in a quieter residential setting.





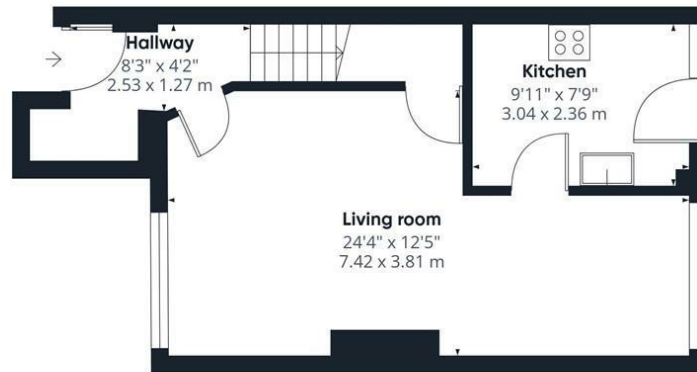

Ground floor



Floor 1



Approximate total area⁽¹⁾
753 ft²
70 m²

(1) Excluding balconies and terraces

Reduced headroom
..... Below 5 ft/1.5 m

Calculations reference the RICS IPMS 3C standard. Measurements are approximate and not to scale. This floor plan is intended for illustration only.

GIRAFFE360

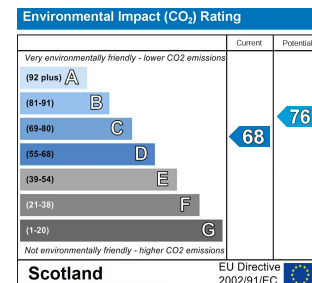
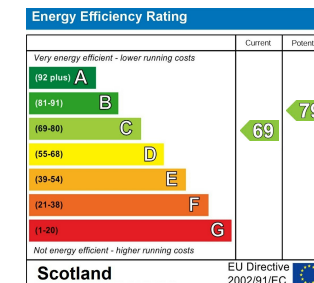
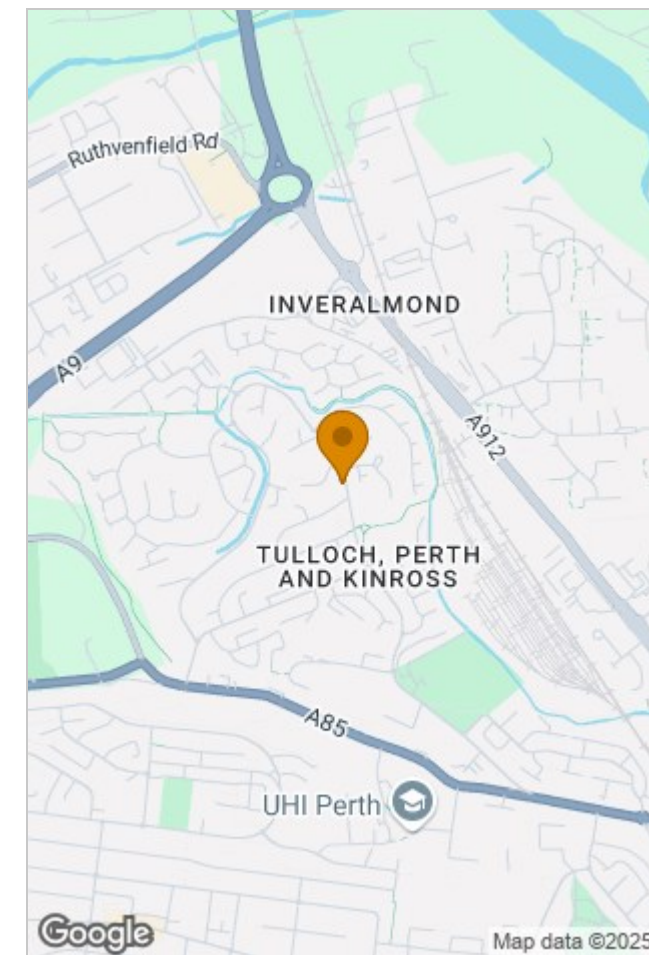

Viewing

Please contact our Perth Office on 01738 260 035 if you wish to arrange a viewing appointment for this property or require further information.

The particulars are set out as a general outline only for the guidance of intended purchasers or lessees, and do not constitute, any part of a contract. Nothing in these particulars shall be deemed to be a statement that the property is in good structural condition or otherwise nor that any of the services, appliances, equipment or facilities are in good working order. Purchasers should satisfy themselves of this prior to purchasing.