



7 WALDEN ROAD

CITY OF PORTSMOUTH, PO2 8PH

£219,995

FREEHOLD

Located with in the requested Stamshaw village area of Portsmouth an established terraced district circa 1900 which offers a wide range of local amenities and is situated within the immediate vicinity of Alexandra Park, which offers open green spaces spaces, shore line pedestrian walks and cycle paths along the inner waterway and the Mountbatten Sports center. This mid terraced house has been refurbished and redecorated by the present owners, blending contemporary styling with period architecture. The accommodation comprises two partially open plan reception rooms, a modernised kitchen breakfast room, a modernised family bathroom and two double bedrooms to the upper floor. Features include a southerly aspect landscaped town garden with full width garden store ideal for home office.



THIS FLOOR PLAN IS NOT DRAWN TO SCALE & IS FOR GUIDANCE PURPOSES ONLY

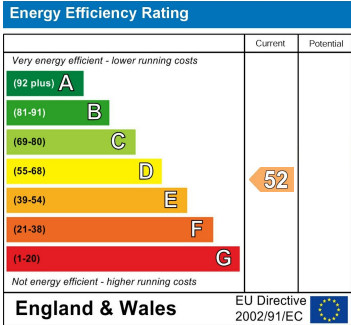
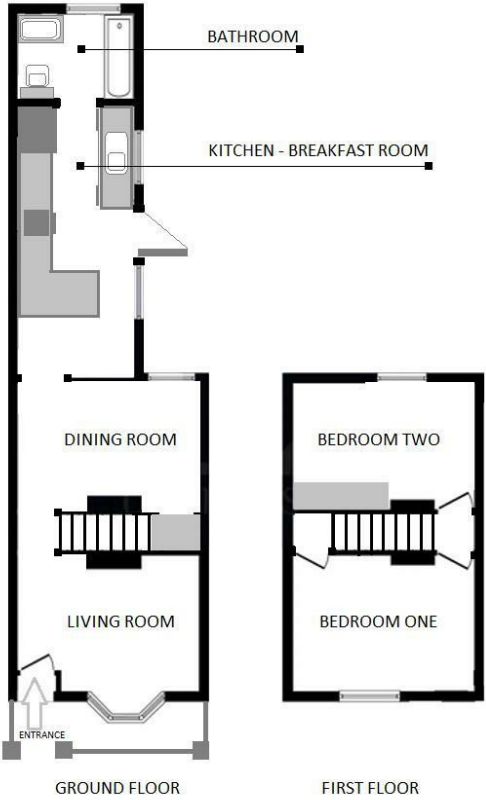

Agents Note: Whilst every care has been taken to prepare these particulars, they are for guidance purposes only. All measurements are approximate and are for general guidance purposes only and whilst every care has been taken to ensure their accuracy, they should not be relied upon and potential buyers/tenants are advised to recheck the measurements

Southsea Office Sales
97 Albert Road
Southsea
Hampshire
PO5 2SG

02392 830888
sales@christieuk.com
www.christieuk.com

