



Taylor Phelps

Hoppet Court, Trinity Lane, Waltham Cross EN8 7EW

£1,200 per calendar month



1



1

Taylor Phelps

Estate Agency



*Taylor Phelps are pleased to offer this modern one bedroom first floor apartment available to rent. This property benefits from an open plan kitchen, double glazing, gas heating and allocated parking to the rear. Furthermore the convenience of Theobalds train station which serves central London is close by.*







Taylor Phelps



Taylor Phelps



Taylor Phelps



Taylor Phelps

Floor Plan

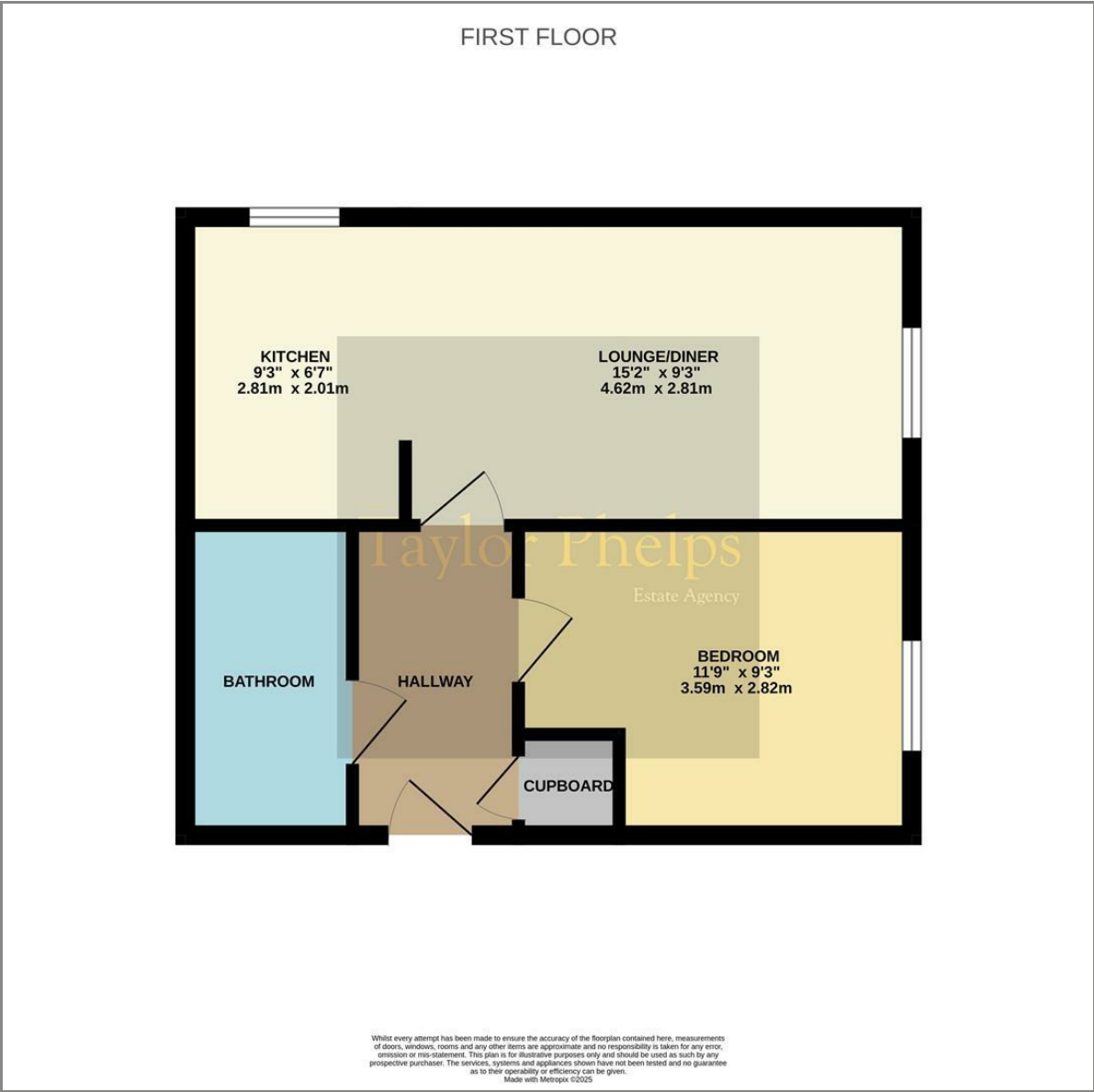

Area Map

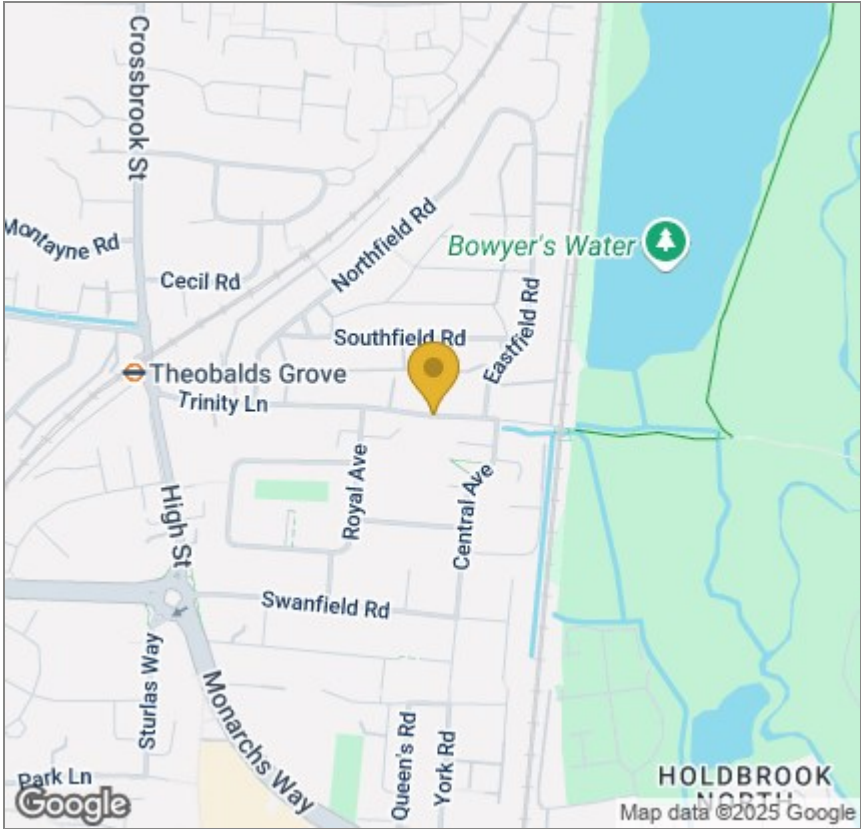

Energy Efficiency Graph

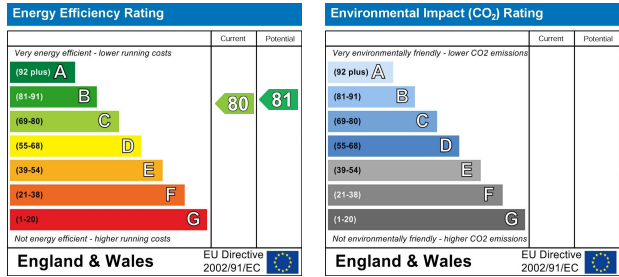

These particulars, whilst believed to be accurate are set out as a general outline only for guidance and do not constitute any part of an offer or contract. Intending purchasers should not rely on them as statements of representation of fact, but must satisfy themselves by inspection or otherwise as to their accuracy. No person in this firms employment has the authority to make or give any representation or warranty in respect of the property.