



Bowsher Court, Ware SG12 7EB

Guide price £260,000



2



2

Taylor Phelps

Estate Agency

Estate Agency

Taylor Phelps are pleased to offer this modern two bedroom apartment positioned within the ever popular and sought after Bowsher Court development close to Ware high street and train station. Gated residents parking. Available Chain Free





Mon - Sat
8am - 6:30 pm

Bowsher Court

Taylor Phelps
Estate Agency

Floor Plan

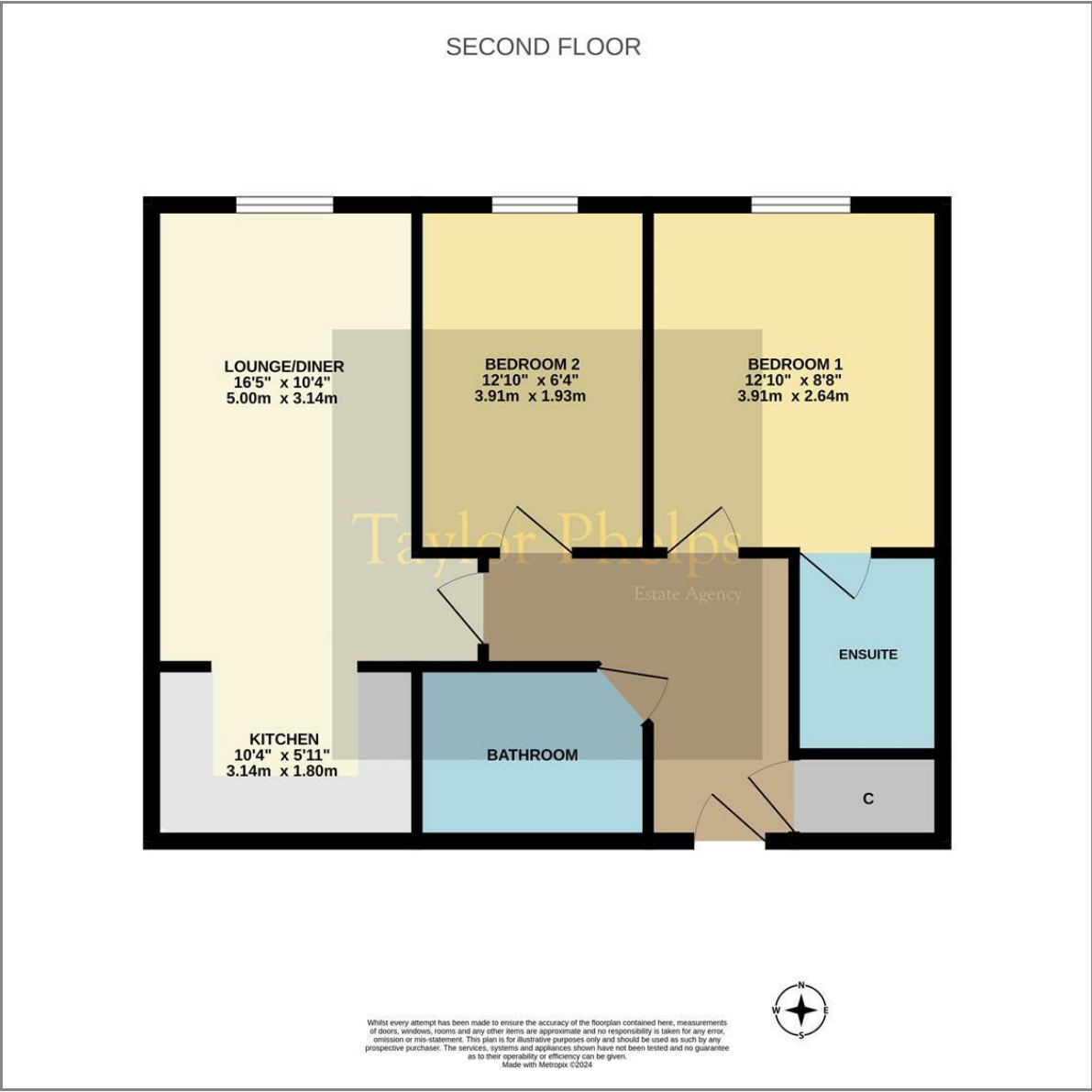

Area Map

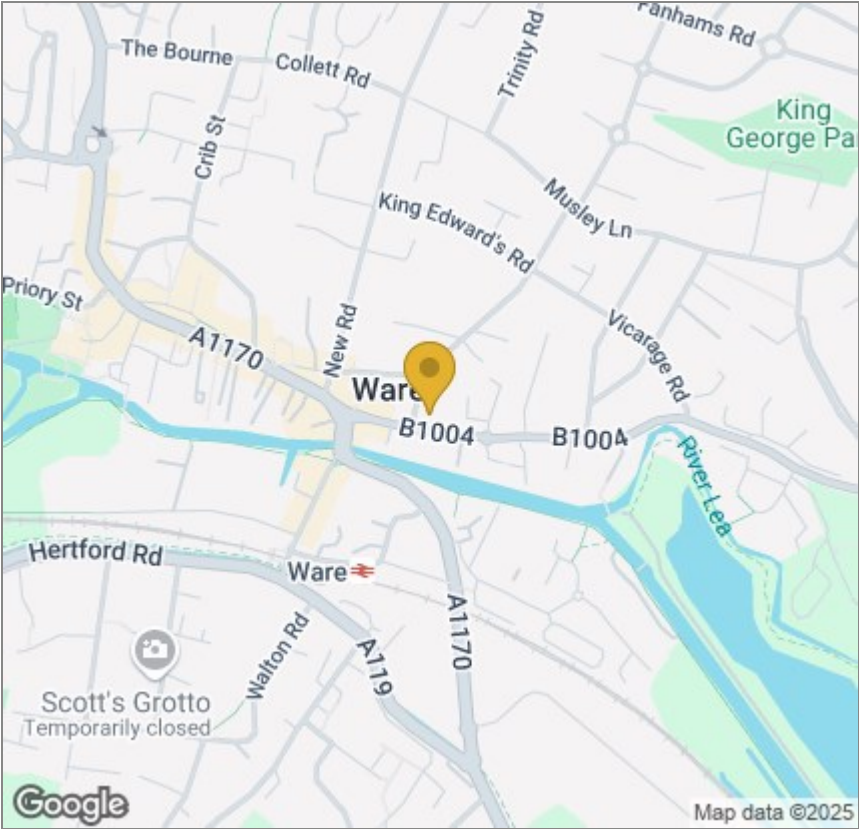

Energy Efficiency Graph

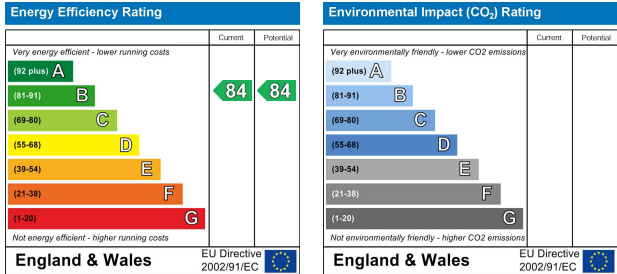

These particulars, whilst believed to be accurate are set out as a general outline only for guidance and do not constitute any part of an offer or contract. Intending purchasers should not rely on them as statements of representation of fact, but must satisfy themselves by inspection or otherwise as to their accuracy. No person in this firms employment has the authority to make or give any representation or warranty in respect of the property.