



Lady Margaret Gardens, Ware SG12 7QB

£212,500

Taylor Phelps



1



1

Taylor Phelps

Estate Agency

Floor Plan

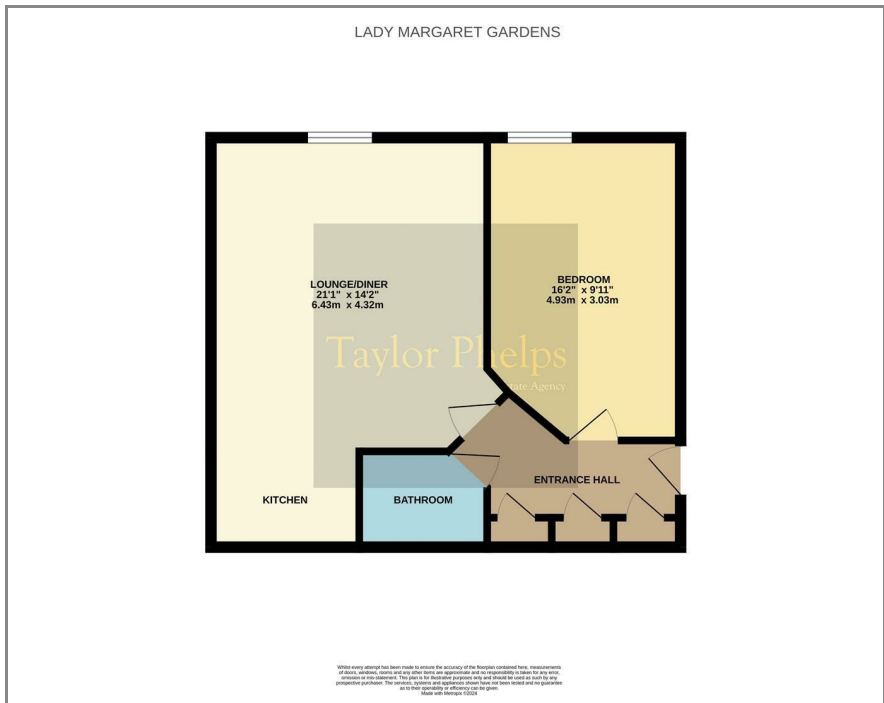

Area Map

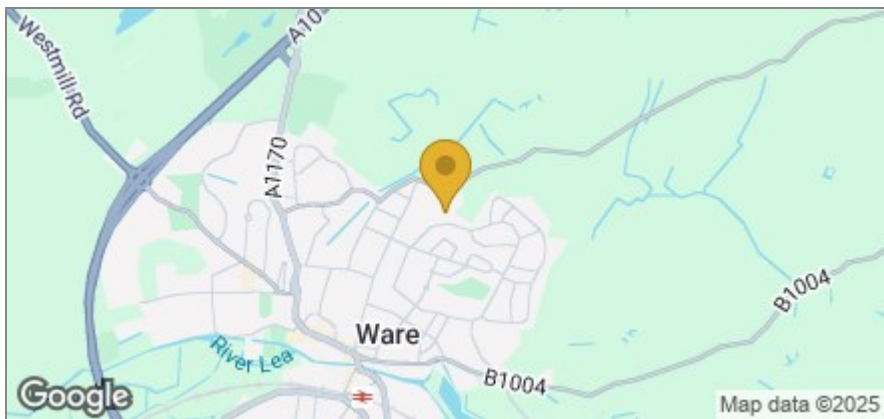

Taylor Phelps are pleased to offer this rarely available one bedroom apartment positioned at Lady Margaret Gardens in Ware. This second floor apartment offers bright and spacious accommodation throughout and further benefits from allocated parking.



Energy Efficiency Graph

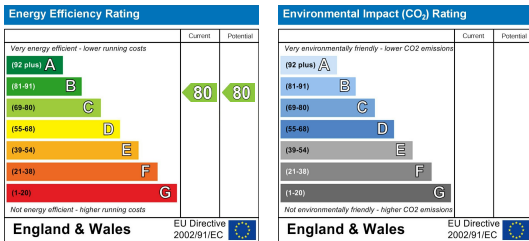

These particulars, whilst believed to be accurate are set out as a general outline only for guidance and do not constitute any part of an offer or contract. Intending purchasers should not rely on them as statements of representation of fact, but must satisfy themselves by inspection or otherwise as to their accuracy. No person in this firm's employment has the authority to make or give any representation or warranty in respect of the property.

01920 459000

hello@taylorphelps.co.uk

5 Frenchs Yard, Amwell End, Ware, Hertfordshire, SG12 9HP

www.taylorphelps.co.uk

rightmove

Zoopla.co.uk

PRS Property
Redress
Scheme