



Millacres, Station Road, Ware SG12 9PU

£1,250



1



1

Taylor Phelps

Estate Agency



*Taylor Phelps are delighted to offer this modern one bedroom ground floor apartment positioned in the heart of Ware town centre. The property offers secure gated parking & access to the high street and station which offers good links to both Hertford East and London Liverpool Street! Available May.*







Taylor Phelps



Taylor Phelps



Taylor Phelps



Taylor Phelps



Floor Plan

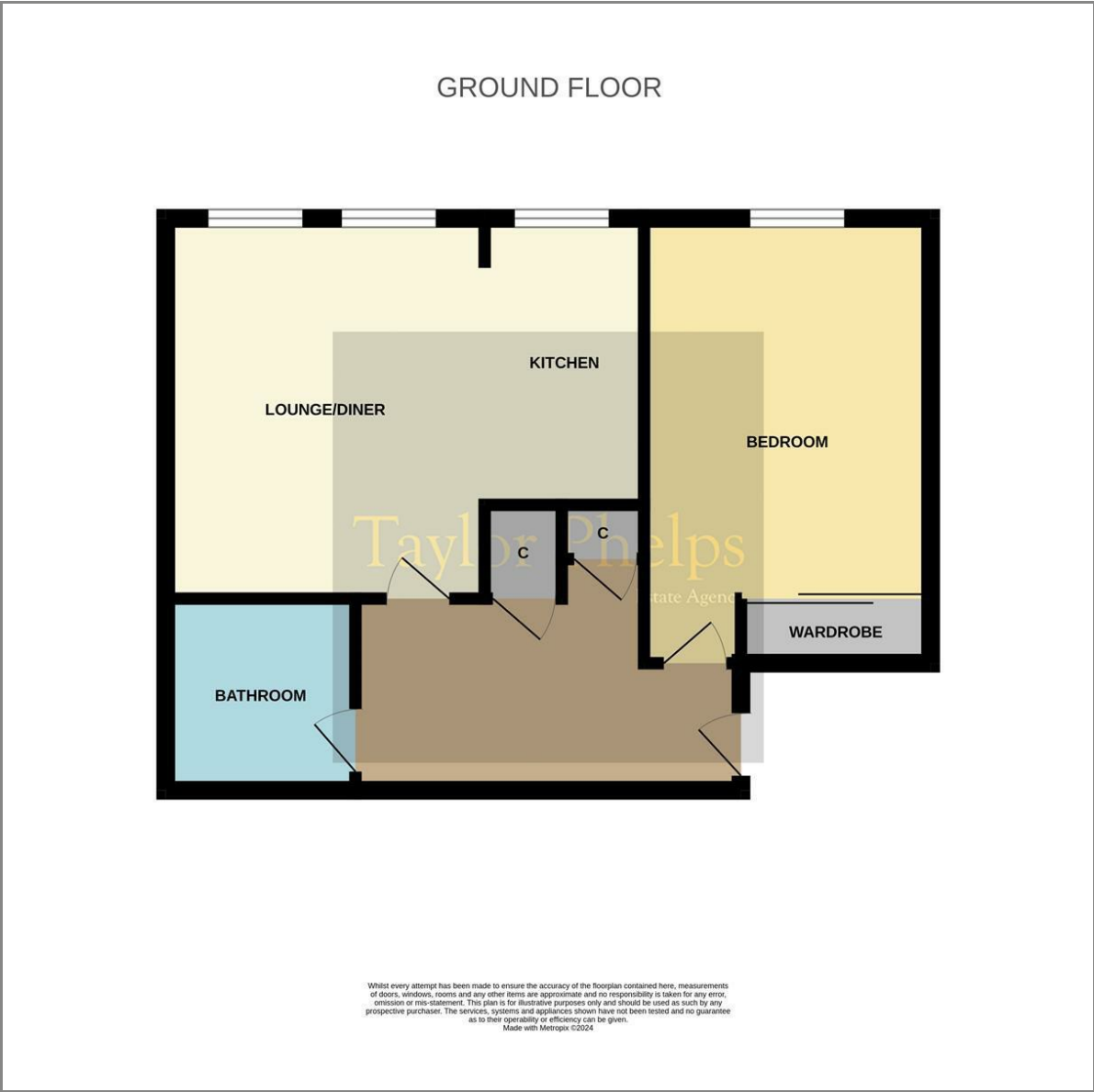

These particulars, whilst believed to be accurate are set out as a general outline only for guidance and do not constitute any part of an offer or contract. Intending purchasers should not rely on them as statements of representation of fact, but must satisfy themselves by inspection or otherwise as to their accuracy. No person in this firms employment has the authority to make or give any representation or warranty in respect of the property.

Area Map



Energy Efficiency Graph

