



Grenville Place

£749,950

A well maintained Four Bedroom house situated on a popular modern development just off Hale Lane, close to local shops and approximately half a mile (approx 10 minute walk) from Mill Hill Broadway's excellent shopping facilities, Thameslink Station and very close to Mathilda Marks Kennedy Primary School.

On The ground the property boasts A bedroom, bathroom and garage. On the first floor there is a bright and airy reception room, large kitchen - breakfast room, utility room and ample storage. On the second floor there is a master bedroom with en-suite 2 further bedrooms and a family bathroom. Further benefits include additional off-street parking and potential to convert the garage stpp. Sole Agent. Chain Free.

Viewing

Please contact our Mill Hill Office on 020 8959 0011 if you wish to arrange a viewing appointment for this property or require further information.



Floor Plan

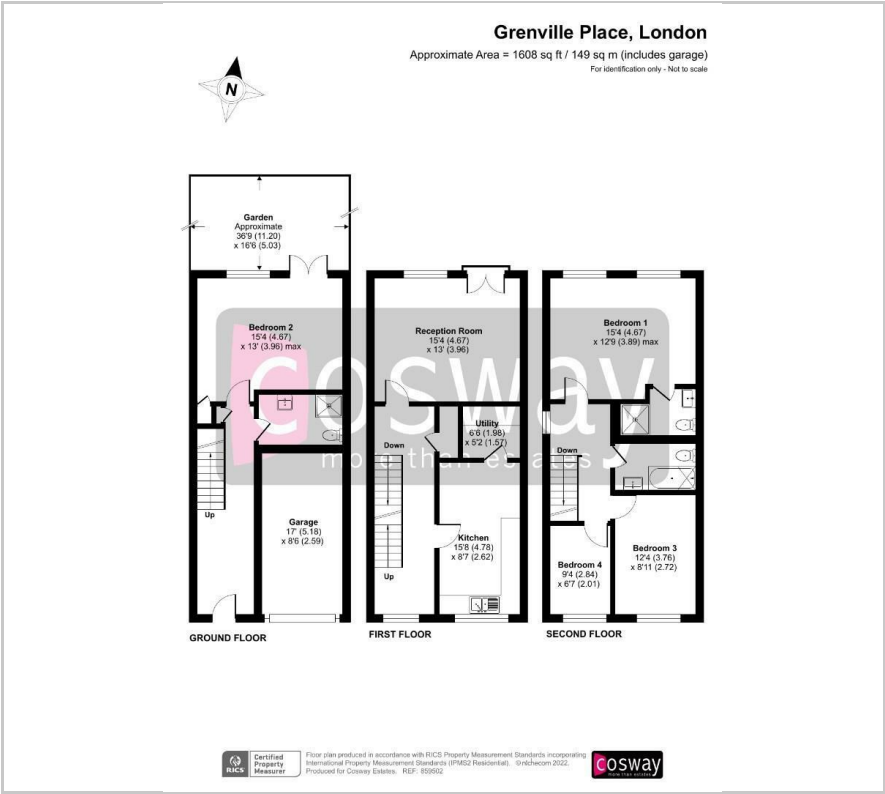

Area Map



Energy Efficiency Graph

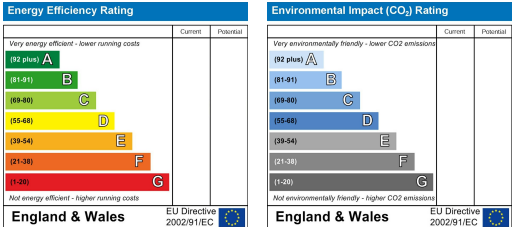

These particulars, whilst believed to be accurate are set out as a general outline only for guidance and do not constitute any part of an offer or contract. Intending purchasers should not rely on them as statements of representation of fact, but must satisfy themselves by inspection or otherwise as to their accuracy. No person in this firms employment has the authority to make or give any representation or warranty in respect of the property.