



Newcombe Park

£3,750

Cosway Estates are pleased to offer for rent this stunning large newly decorated four double bedroom semi-detached house situated in a quiet tree-lined road, moments to Mill Hill Broadway's shops, restaurants, coffee shops and Thameslink train station. The property comprises of four spacious bedrooms; three bathrooms; two reception rooms and large modern fitted kitchen. This property also benefits from a private rear garden and off-street parking for 2 cars. AVAILABLE JULY 2023. Viewings highly advised.

Viewing

Please contact our Mill Hill Office on 020 8959 0011 if you wish to arrange a viewing appointment for this property or require further information.



4



3



2



Floor Plan

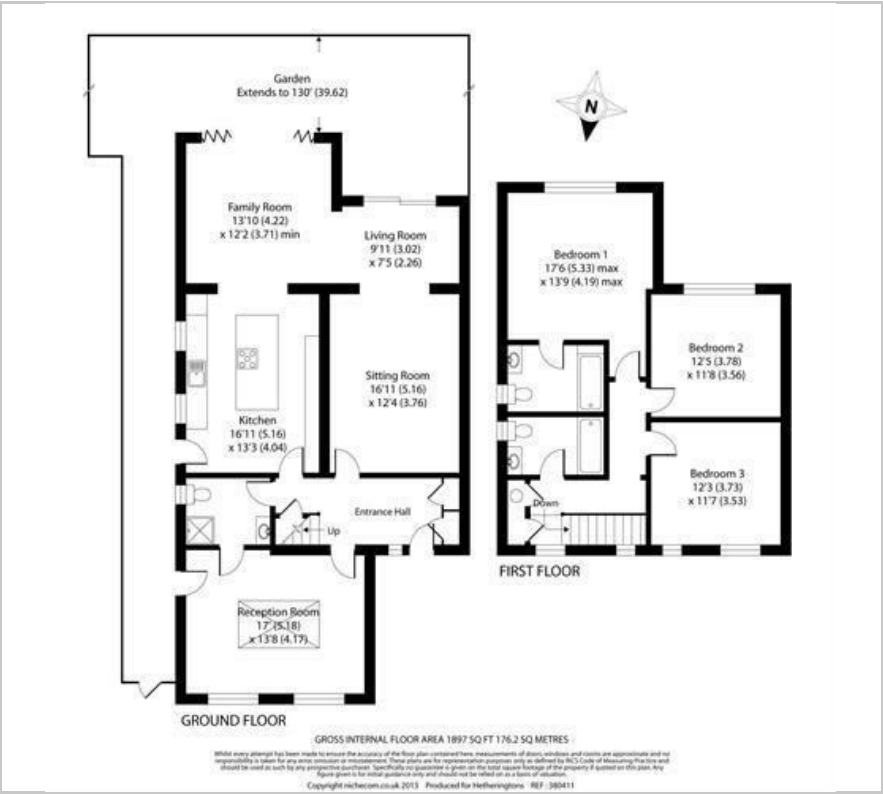

Area Map



Energy Efficiency Graph



These particulars, whilst believed to be accurate are set out as a general outline only for guidance and do not constitute any part of an offer or contract. Intending purchasers should not rely on them as statements of representation of fact, but must satisfy themselves by inspection or otherwise as to their accuracy. No person in this firms employment has the authority to make or give any representation or warranty in respect of the property.