



Austell Gardens

£2,100 Per Month

Cosway Estates are pleased to offer this most appealing and attractive three double bedroom townhouse arranged on three floors and situated on a sought after cul-de-sac off Tretawn Gardens. This property comprises of a large reception room; separate fully fitted kitchen; three double bedrooms; two ensuite bathrooms; a ground floor WC and shower room; utility room; a garage; driveway and a rear garden with decking. Located close to Mill Hill Broadway and in the catchment area for Mill Hill County & Coutland Schools. Available October 2021. VIEWINGS HIGHLY ADVISED.

Viewing

Please contact our Mill Hill Office on 020 8959 0011 if you wish to arrange a viewing appointment for this property or require further information.

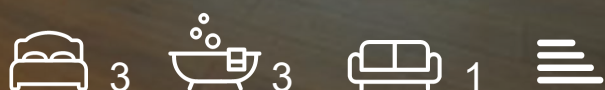

Floor Plan

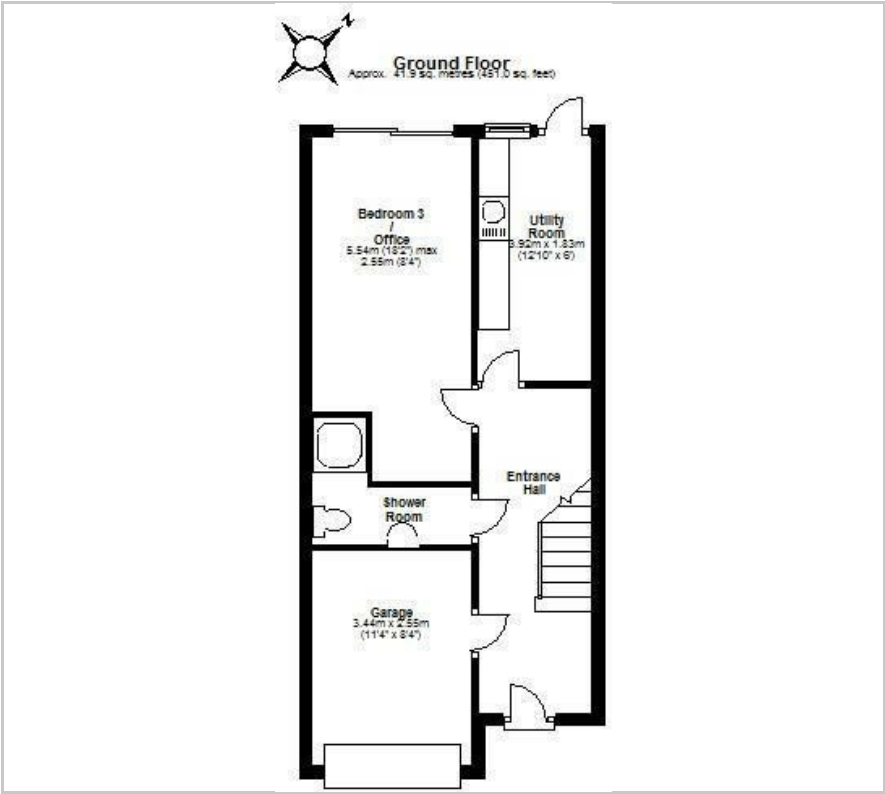

Area Map



Energy Efficiency Graph

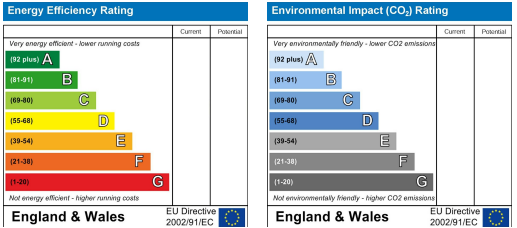

These particulars, whilst believed to be accurate are set out as a general outline only for guidance and do not constitute any part of an offer or contract. Intending purchasers should not rely on them as statements of representation of fact, but must satisfy themselves by inspection or otherwise as to their accuracy. No person in this firms employment has the authority to make or give any representation or warranty in respect of the property.