



## Priory Field Drive

**£1,095,000**

2109 sq ft - Cosway are pleased to offer for sale this Five Bedroom, Three Bathroom (Two en-suite) detached family house located in a sought after development with easy access to both Edgware and Mill Hill's transport links, shops and schools.

The property offers 2109 sq ft/196.2 sq m of fantastic living space over two floors with accommodation including a Kitchen/Breakfast room, Formal Reception Room, Family Room, Study, Utility Room & Guest Wc.

Amenities include off street parking for several cars, rear garden and large patio area.

Prioryfield Drive is within approximately 3/4 of a mile of Edgware (Northern Line) Station and is within the Edgware Eruv. Mill Hill's Thameslink Station is approximately 1 mile away. Chain Free.

### Viewing

Please contact our Mill Hill Office on 020 8959 0011 if you wish to arrange a viewing appointment for this property or require further information.



5



3



3

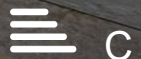

C

# Floor Plan

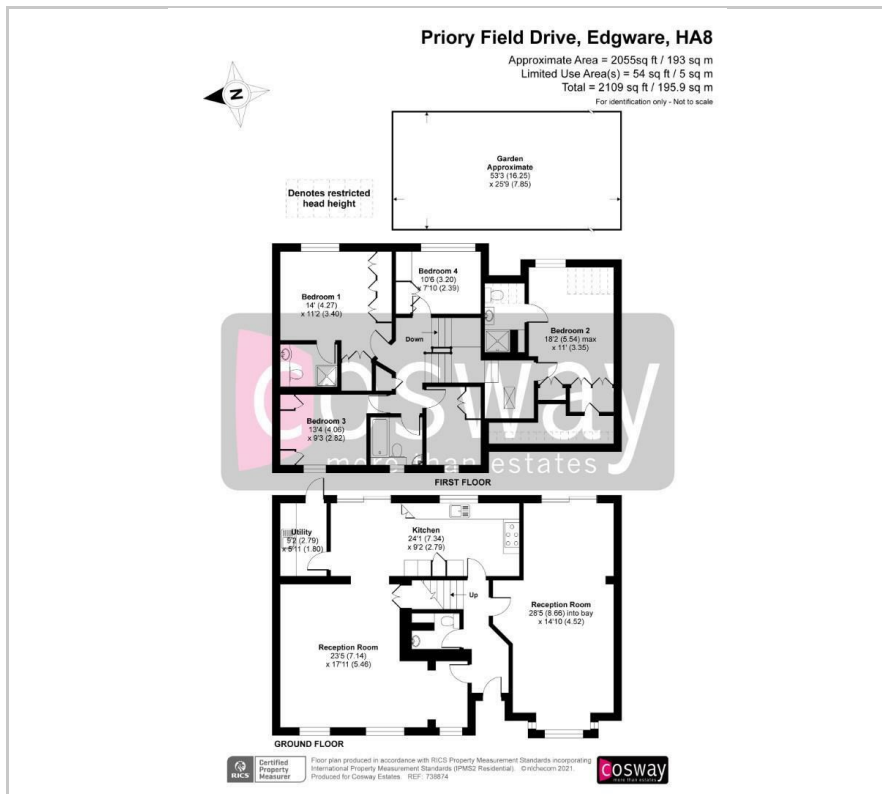

# Area Map



# Energy Efficiency Graph

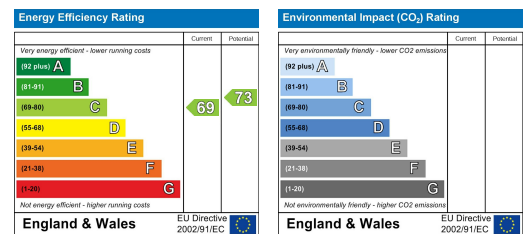

These particulars, whilst believed to be accurate are set out as a general outline only for guidance and do not constitute any part of an offer or contract. Intending purchasers should not rely on them as statements of representation of fact, but must satisfy themselves by inspection or otherwise as to their accuracy. No person in this firm's employment has the authority to make or give any representation or warranty in respect of the property.