



Orchard Close

Offers In Excess Of £545,000

Situated on a wide plot, is this superb 3 bedroom property situated in Orchard Close in Radlett. Worked on extensively by the current owners the house presents itself as a modern, stylish family home. The first floor comprises: Welcoming entrance hall, spacious through lounge, stunning kitchen, open plan living / dining space, adjoining reception room with doors onto a well maintained garden, in addition to a downstairs bathroom and store room. The first floor encompasses the family bathroom and 3 spacious bedrooms all in fantastic decorative order. Externally, the property benefits from a set back frontage with off-street and to the rear a secluded garden space well suited to entertaining. SOLE AGENT

Viewing

Please contact our Mill Hill Office on 020 8959 0011 if you wish to arrange a viewing appointment for this property or require further information.



3



1



2



Floor Plan

Area Map

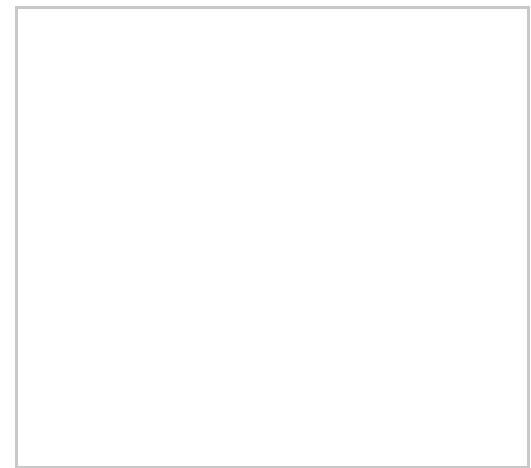
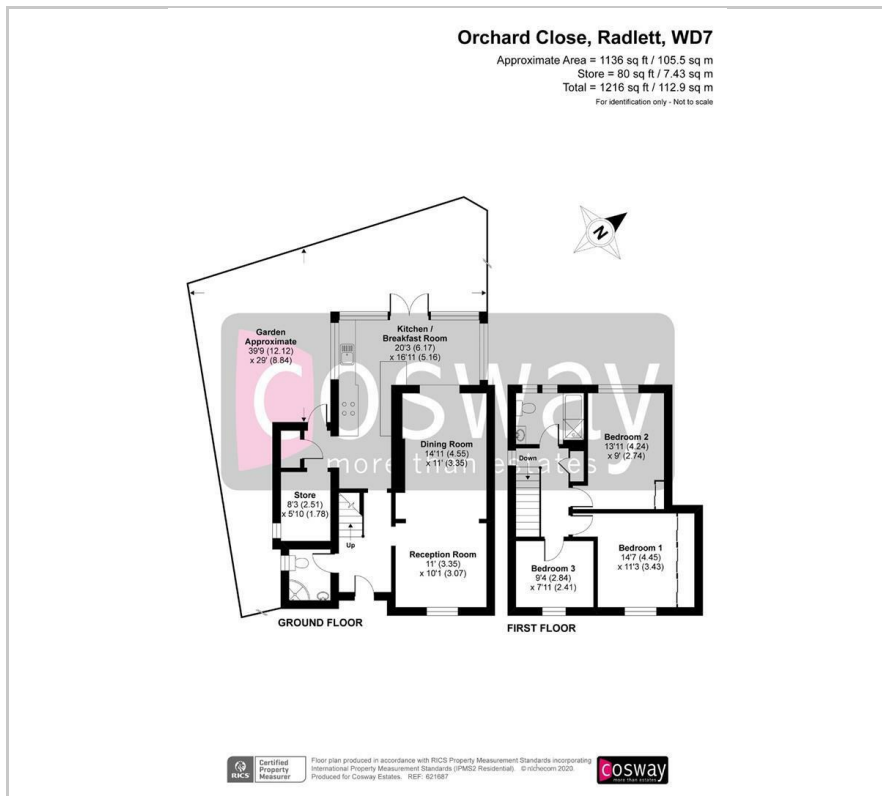

Energy Efficiency Graph

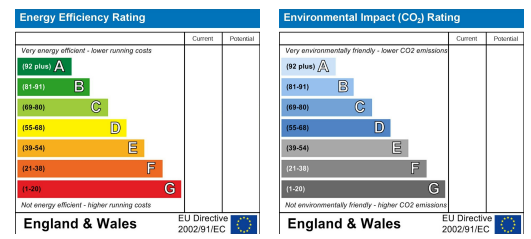

These particulars, whilst believed to be accurate are set out as a general outline only for guidance and do not constitute any part of an offer or contract. Intending purchasers should not rely on them as statements of representation of fact, but must satisfy themselves by inspection or otherwise as to their accuracy. No person in this firm's employment has the authority to make or give any representation or warranty in respect of the property.