



Romford Road

, Holbrooks, CV6 4FS

£1,150 PCM



Pointons Estate Agents are delighted to present this well-proportioned three-bedroom semi-detached home, situated on Romford Road in the popular Holbrooks area of Coventry.

Ideally located within easy reach of local shops, reputable schools and a range of everyday amenities, the property also benefits from gas central heating and double glazing throughout.

The accommodation briefly comprises a welcoming entrance hall, a bright and spacious living room opening through to the dining area, and a fitted kitchen. To the first floor, there are three well-sized bedrooms and a modern shower room.

Externally, the property offers a lawned garden to the front, while the rear garden is predominantly laid to lawn with a decked seating area—ideal for outdoor entertaining. Additional benefits include a functional outside WC and two useful store rooms, both with power and lighting.

This property would make an excellent family home. Viewings are strictly by appointment via the agent.



Living Room 14'1" x 11'10" (4.30m x 3.60m)

Double glazed bay window to front, laminate flooring, radiator, fireplace with wooden surround and coving to ceiling.

Dining Room 9'10" x 9'10" (3.00m x 3.00m)

With double glazed french doors to rear garden, laminate flooring, radiator and coving to ceiling.

Kitchen 9'10" x 7'10" (3.00m x 2.40m)

Fitted with a matching range of base and eye level units with worktop space over, composite sink unit with single drainer and taps over, space for cooker with extractor hood over, tiled splashbacks and flooring, double glazed windows to side and rear and door leading to rear garden.

Bedroom 13'9" x 12'2" (4.20m x 3.70m)

Double glazed bay window to front, carpeted, radiator and storage cupboard.

Bedroom 10'2" x 12'2" (3.10m x 3.70m)

Double glazed window to rear, carpeted, radiator and storage cupboard.

Bedroom 10'2" x 6'11" (3.10m x 2.10m)

Double glazed window to front, carpeted, radiator and storage cupboard.

Shower Room 7'7" x 5'7" (2.30m x 1.70m)

Fitted with a shower cubicle and sliding screen, low level WC, hand wash basin with mixer tap and built in storage beneath, tiled splashbacks and flooring, obscure double glazed window to rear.

Store Room 13'5" x 15'5" (4.10m x 4.70m)

Entrance via double glazed door with double glazed window, power points and lighting.

Area Map

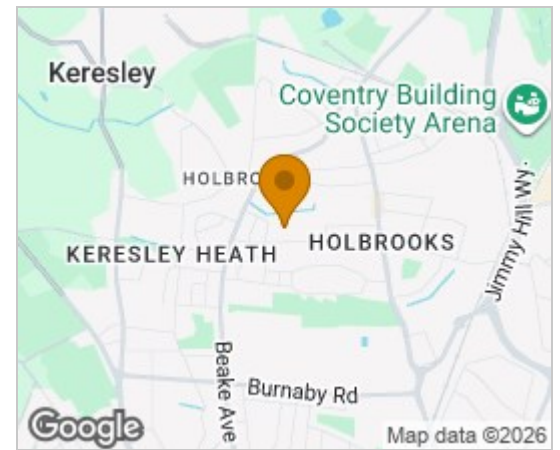

Floor Plans

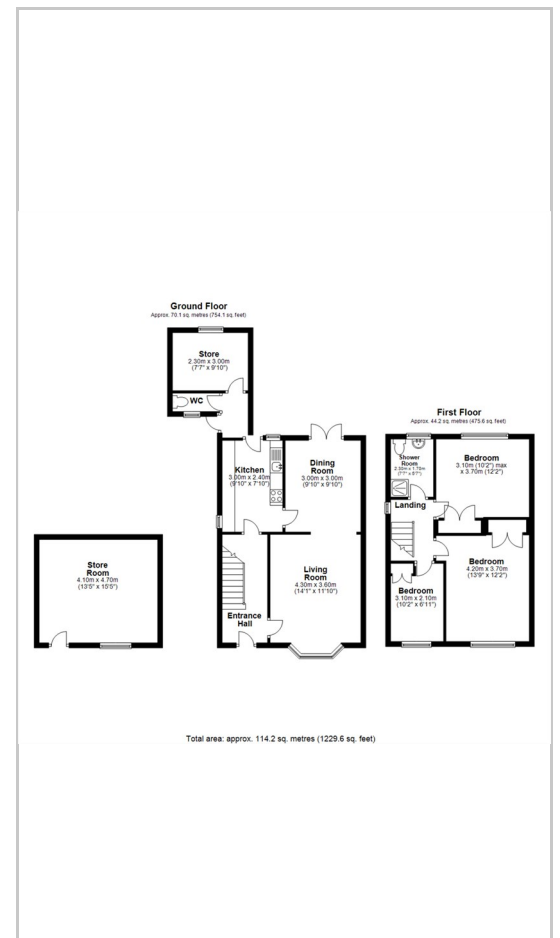

Energy Efficiency Graph

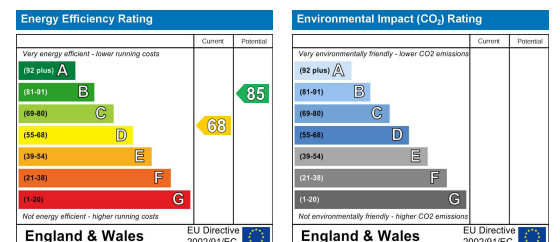

These particulars, whilst believed to be accurate are set out as a general outline only for guidance and do not constitute any part of an offer or contract. Intending purchasers should not rely on them as statements of representation of fact, but must satisfy themselves by inspection or otherwise as to their accuracy. No person in this firm's employment has the authority to make or give any representation or warranty in respect of the property.

109 NEW UNION STREET
COVENTRY, CV1 2NT
coventry@pointons-group.com
024 7710 333
Company No: 7359350

BOND GATE CHAMBERS
NUNEATON, CV11 4AL
nuneaton@pointons-group.com
024 7637 3300
Company No: 6743033

74 LONG STREET
ATHERSTONE, CV9 1AU
atherstone@pointons-group.com
01827 711911
Company No: 81323250



www.pointons-group.com

VAT NO 742186125