



Whitmore Manor Close

, Coventry, CV6 2PH

£1,250



Pointons are proud to bring to the market this modern 2.5 story semi detached house in the popular location of Holbrooks. Close to amenities and schools such as Whitmore park, Holy Family and President Kennedy, this property is in prime location for families

In brief the property benefits of; an entrance hallway, large open plan kitchen/diner, ground floor w/c, spacious lounge with patio door to the garden. To the first floor you will find bedrooms two and three and the family bathroom. The second floor is home the the master bedroom with en-suite shower room.

Externally the property offer a drive way for two vehicles at the front with a fully enclosed lawned garden to the rear.
An internal inspection is highly recommended, viewings strictly via the agent

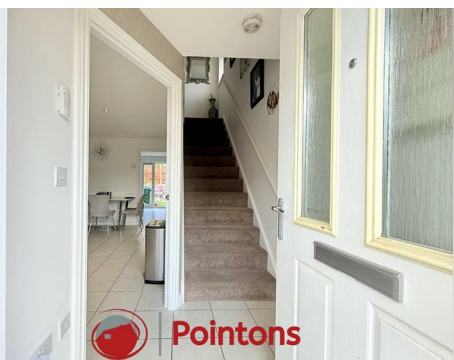

Entrance Hall 11'0" x 4'11" (3.35m x 1.49m)
Stairs, door.

Kitchen/Diner 17'3" x 11'1" (5.26m x 3.39m)
Window to front, door to:

WC 5'11" x 4'1" (1.81m x 1.24m)
Door to:

Living Room 11'4" x 15'6" (3.45m x 4.73m)
Two windows to rear, double door, door to:

Landing 7'10" x 8'1" (2.38m x 2.47m)
Door to:

Bedroom 2 11'4" x 15'6" (3.45m x 4.73m)
Window to rear, Storage cupboard, stairs, door to:

Bathroom 6'4" x 7'1" (1.93m x 2.15m)
Door to:

Bedroom 3 10'7" x 7'1" (3.23m x 2.15m)
Window to front, door to:

Landing 9'1" x 8'1" (2.78m x 2.47m)
Window to front.

Master Bedroom 19'8" x 15'6" (6.00m x 4.73m)
Box window to front, window to rear, door to:

En-suite 7'0" x 4'8" (2.14m x 1.41m)
Window to rear.

Area Map



Floor Plans

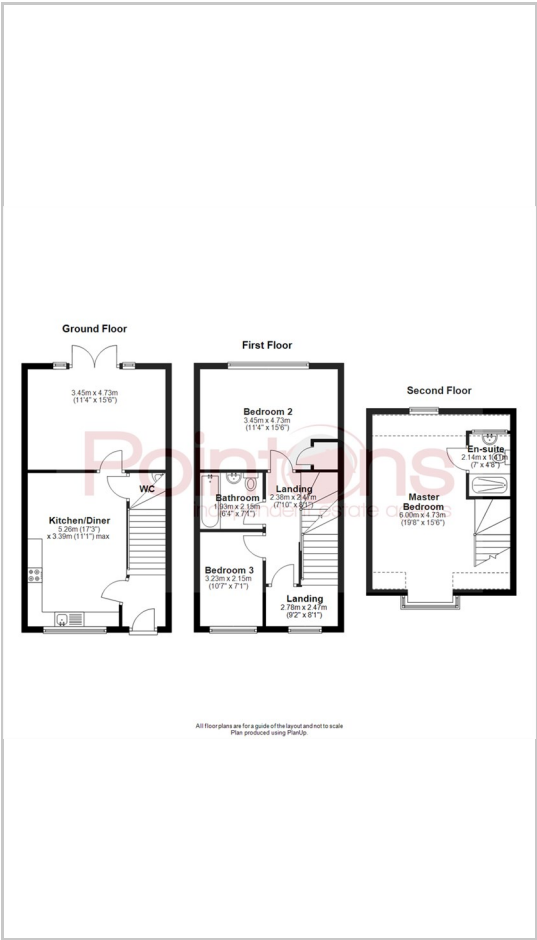

Energy Efficiency Graph

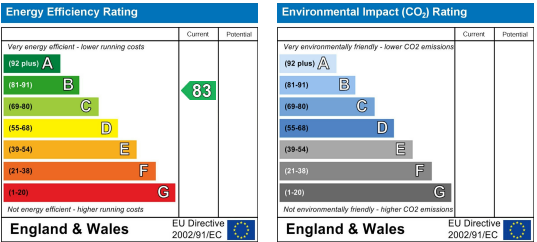

These particulars, whilst believed to be accurate are set out as a general outline only for guidance and do not constitute any part of an offer or contract. Intending purchasers should not rely on them as statements of representation of fact, but must satisfy themselves by inspection or otherwise as to their accuracy. No person in this firm's employment has the authority to make or give any representation or warranty in respect of the property.

109 NEW UNION STREET
COVENTRY, CV1 2NT
coventry@pointons-group.com
024 7710 333
Company No: 7359350

BOND GATE CHAMBERS
NUNEATON, CV11 4AL
nuneaton@pointons-group.com
024 7637 3300
Company No: 6743033

74 LONG STREET
ATHERSTONE, CV9 1AU
atherstone@pointons-group.com
01827 711911
Company No: 81323250



www.pointons-group.com

VAT NO 742186125