



40 Burfoote Gardens, Bristol, BS14 8TE

£290,000

We are delighted to present this immaculate terraced house for sale, boasting a sought after location near local amenities. This property is a real gem, benefiting from a host of unique features and a high standard of finish throughout.

This stunning home boasts four bedrooms, including two generous double rooms and two good size single rooms, making it an ideal choice for families, first-time buyers, or investors. Each of the bedrooms is tastefully decorated and well-appointed, offering a comfortable and relaxing personal space.

This property features a sitting room to the front with large windows, allowing for an abundance of natural light and creating a pleasant and welcoming atmosphere. The open-plan kitchen is a notable feature, with ample dining space, access to the garden, and a utility space. It is flooded with natural light, perfect for cooking and entertaining.

Entrance Hall

Sitting Room

18'4" x 13'10" (5.59 x 4.23)



Kitchen / Diner

13'10" x 12'11" (4.23 x 3.96)



Utility Space

Ground Floor WC

First Floor Landing



Bedroom One

12'10" x 9'11" (3.92 x 3.03)



Bedroom Two

10'0" x 10'0" (3.07 x 3.05)



Bedroom Three

10'0" x 7'1" (3.07 x 2.17)



Bedroom Four

9'10" x 7'0" (3.01 x 2.15)



Garage

15'10" x 7'8" (4.83 x 2.35)



Shower Room

7'9" x 7'0" (2.38 x 2.15)



Agent Note

There is a service charge to maintain the surrounding green spaces in 2025 this is £26 per month

Outside



Floor Plan

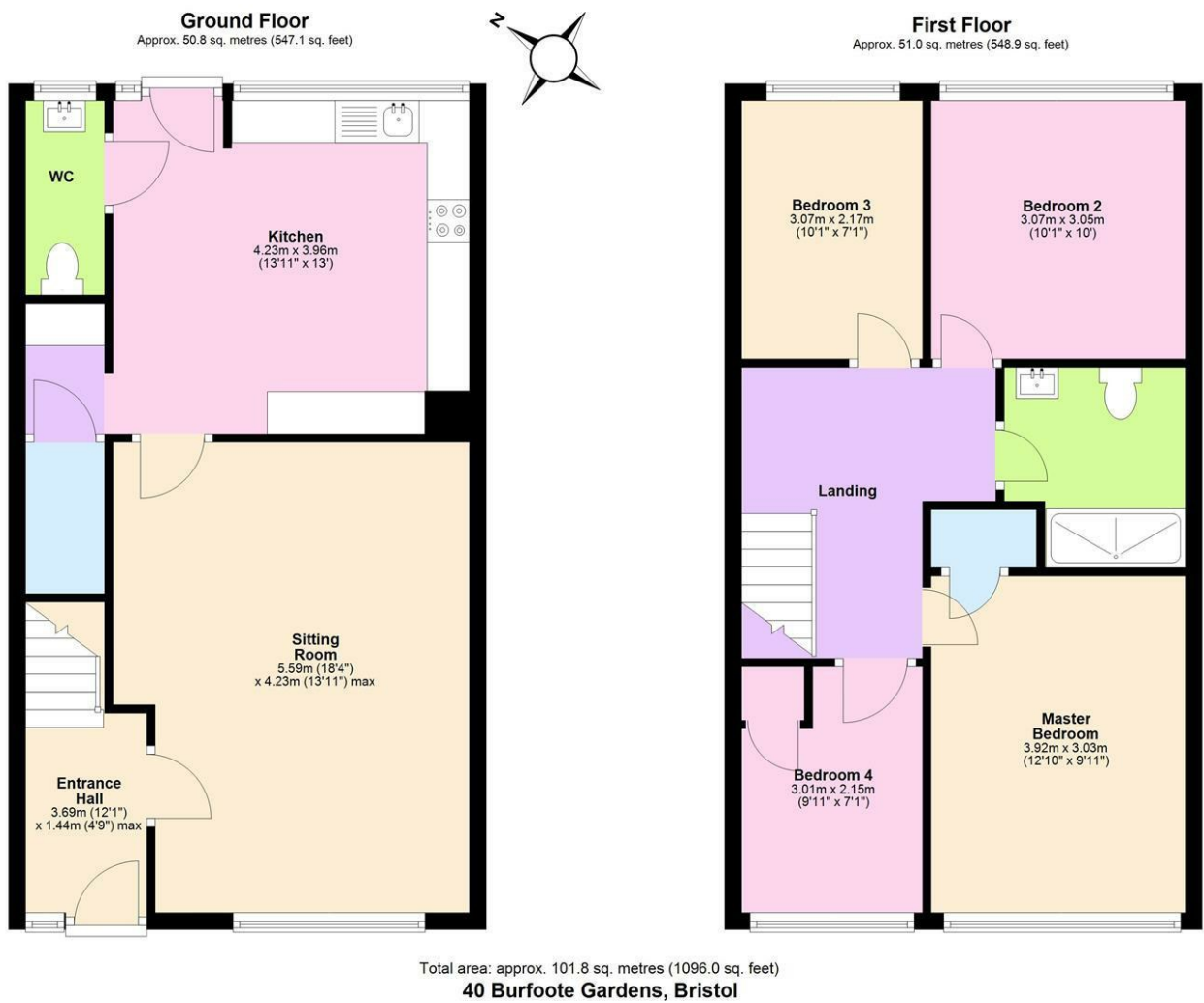

Area Map



Energy Efficiency Graph

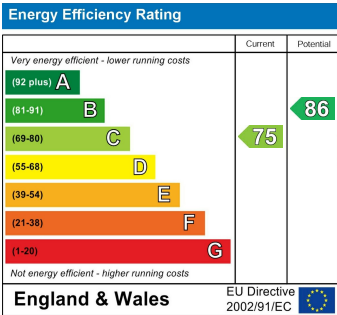

These particulars, whilst believed to be accurate are set out as a general outline only for guidance and do not constitute any part of an offer or contract. Intending purchasers should not rely on them as statements of representation of fact, but must satisfy themselves by inspection or otherwise as to their accuracy. No person in this firms employment has the authority to make or give any representation or warranty in respect of the property.