



Susan Payne
PROPERTY

PROUDLY PRESENT FOR SALE

15, Purdy Road

Newport, Isle of Wight PO30 5SU



£315,000
FREEHOLD



Offered for sale chain free, 15 Purdy Road is a beautifully presented three-bedroom home offering light and bright interiors, generous accommodation, garden, garage and driveway, set in a convenient location close to local amenities.

- Three-bedroom semi-detached home offered for sale CHAIN FREE
- Private driveway parking for multiple vehicles, and a garage
- Far-reaching views across the rooftops from the upper floor
- Conveniently located near primary and secondary schools
- Excellent public transport links via the Southern Vectis route 38
- Low maintenance garden complete with a useful outbuilding
- Bright and airy accommodation ready for personalisation
- Stylish bathroom with rainfall shower and modern fittings
- Easy access to Newport town centre and Carisbrooke amenities
- Well-maintained property ideal for a wide range of buyers

For more information and to arrange a viewing, please contact Susan Payne Property on **01983 566244**.

Preview our newest listings first!
Search on Facebook for:

Susan Payne Property
Home Hunters

rightmove

Zoopla

OnTheMarket.com

PrimeLocation

The Property Ombudsman

You can also email us at sales@susanpayneproperty.co.uk, visit our website at susanpayneproperty.co.uk or visit us at East Quay, Wootton Bridge, Isle of Wight PO33 4LA. You can also follow us on Facebook, Twitter and Instagram.



Well-maintained and presented throughout, this light and airy three-bedroom home offers comfortable accommodation with a tasteful neutral finish, creating a blank canvas ready for a new owner to make their own. The property benefits from generously proportioned bedrooms, a stylishly updated bathroom, and bright living spaces, all conveniently positioned within easy reach of Newport and Carisbrooke amenities. Recent upgrades include a new consumer unit (2023) and most windows and the front door replaced recently with brand new units, including integrated ventilation and airflow (2025). Ideal for families, first-time buyers, or investors alike, the home combines practical living space with modern styling and a highly convenient location.

Purdy Road enjoys a convenient position within walking distance of the wide range of amenities available in both Newport and Carisbrooke, including a selection of well-regarded primary and secondary schools. Newport's historic town centre provides an extensive choice of shops, supermarkets, cafés, bars, and restaurants, while nearby Carisbrooke offers a convenience store with post office facilities, popular pubs, respected eateries, and a medical centre with pharmacy services. Regular public transport is easily accessible via the Southern Vectis number 38 bus route, connecting directly to Newport Bus Station and the Island's wider transport network.

Welcome to 15 Purdy Road

Set within a well-established residential area, a driveway provides plenty of parking and leads to the smart front façade of No 15. Internally the accommodation continues with bright interiors, soft neutral tones, and an inviting atmosphere throughout. The neutral presentation and well-balanced layout create a welcoming home suited to a wide range of buyers.

Porch

The useful porch offers a welcoming first impression with contemporary grey décor and glazing to two aspects. A door leads into the living room.

Living Room

A bright and comfortable reception room offering ample space for lounge furnishings, complemented by natural light from the front aspect window and an open feel ideal for everyday living. A contemporary fireplace adds character, and alcoves either side provide storage. A door leads through to the kitchen/diner and stairs give access to the first floor.

Kitchen/Diner

Positioned to the rear of the property, the kitchen/dining space provides a practical and sociable layout with room for dining furniture and direct access to the garden, making it well suited to modern family life. Glossy white cabinets combine with contemporary dark worktops and black metro-tile splashbacks, and the kitchen also benefits from an integrated oven, plus there is plenty of space for further appliances. The kitchen flows into a lobby area that has a full height window looking over the garden and provides access to the ground floor cloakroom.

Cloakroom

Perfectly positioned to serve the ground floor, the cloakroom benefits from a WC and compact vanity basin, white tiling and a feature wallpaper.

First-Floor Landing

Connecting all first-floor rooms, the landing continues the home's fresh and bright presentation with soft décor and a neutral carpet that flows into all three bedrooms.

Bedroom One

A generously proportioned double bedroom benefiting from excellent natural light and a built-in wardrobe. A large window provides an outlook to the front aspect.



Bedroom Two

Another good-sized double bedroom with large built-in wardrobes providing an abundance of storage. A window to the rear aspect provides a far-reaching view over the rooftops of Carisbrooke with Mountjoy on the horizon.

Bedroom Three

A comfortable single bedroom ideal as a child's room, nursery, dressing room, or home office.

Family Bathroom

Beautifully updated with a contemporary finish, the bathroom features striking white subway tiling paired with contrasting dark cabinetry and wood-effect flooring. The suite comprises a panel bath with rainfall shower and glass screen, vanity wash basin, WC, heated towel rail, and built-in storage.

Outside

To the front of the property, the driveway provides convenient off-road parking alongside a neatly maintained frontage. There is access to the garage, which offers further secure storage space and practical versatility, and a side path connects to the rear garden.

The rear garden has been designed with low maintenance in mind, offering an easy-to-manage outdoor space ideal for relaxing or entertaining. An outbuilding makes the most of the space behind the garage and provides useful additional storage, workshop or home-working potential.

In Summary

Offering bright and well-maintained accommodation throughout, this attractive home combines generous accommodation, stylish modern finishes, and a highly convenient location close to local amenities, schools, and transport links. With fresh neutral décor ready for personalisation, the property presents an excellent opportunity for a wide range of buyers and is offered for sale chain free. An early viewing with the sole agent Susan Payne Property is highly recommended.

Additional Details

Tenure: Freehold

Council Tax Band: C (Approx £2386.90 for 2026/27)

Services: Mains water, gas, electricity and drainage



Approx Gross Internal Area
105 sq m / 1132 sq ft

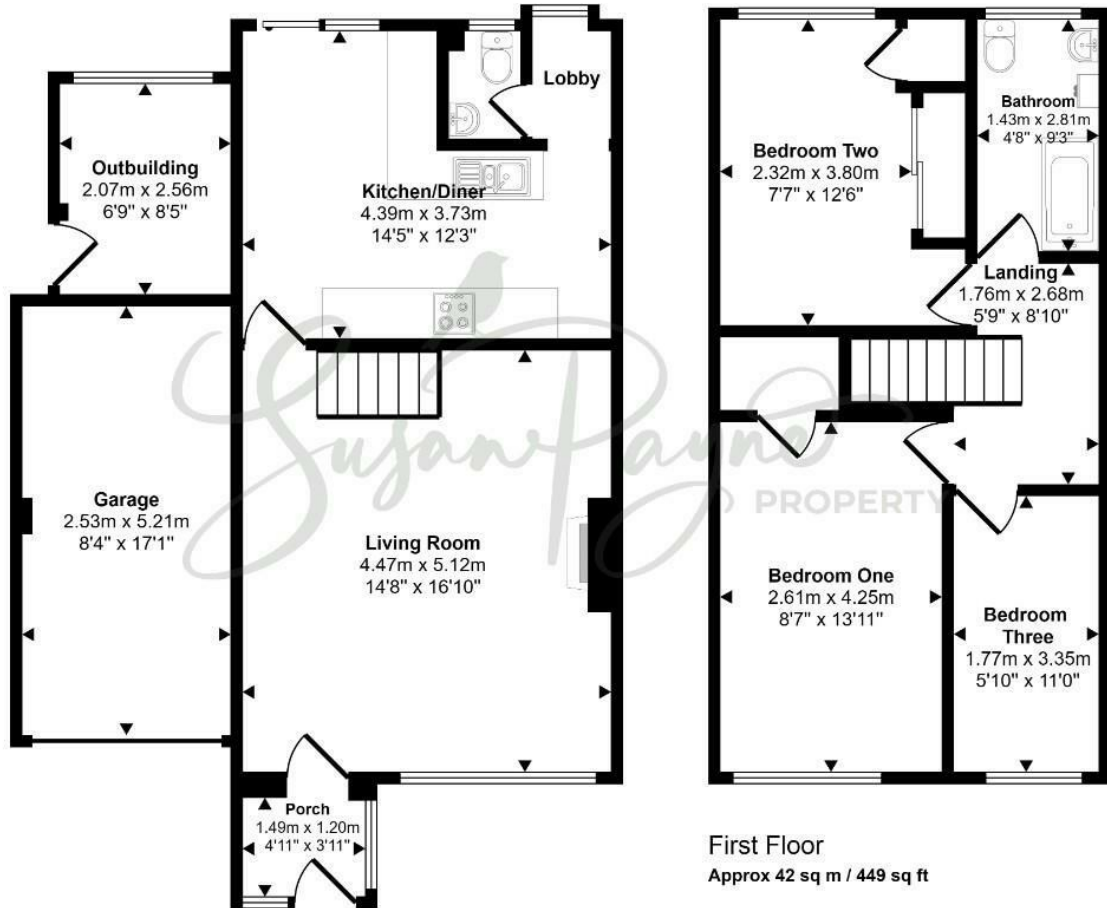

Ground Floor
Approx 63 sq m / 683 sq ft

This floorplan is only for illustrative purposes and is not to scale. Measurements of rooms, doors, windows, and any items are approximate and no responsibility is taken for any error, omission or mis-statement. Icons of items such as bathroom suites are representations only and may not look like the real items. Made with Made Snappy 360.

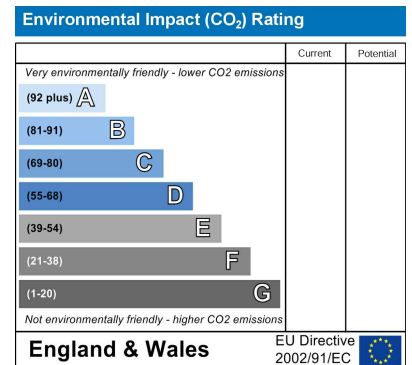
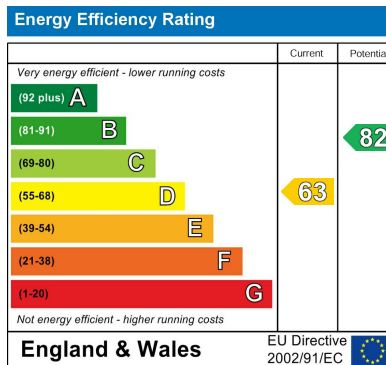
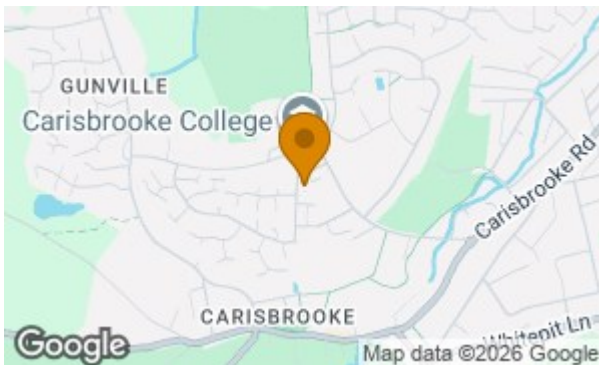

Agent Notes:

The information provided about this property does not constitute or form part of an offer or contract, nor may it be regarded as representations. All interested parties must verify accuracy and your solicitor must verify tenure/lease information, fixtures and fittings and, where the property has been extended/converted, planning/building regulation consents. All dimensions are approximate and quoted for guidance only and their accuracy cannot be confirmed. Reference to appliances and/or services does not imply that they are necessarily in working order or fit for the purpose. Susan Payne Property Ltd. Company no.10753879.