



T₂m

212b Eardley Road

£1,750 PCM

A fantastic two double bedroom maisonette. The property has been recently refurbished to a high standard throughout, offering two large sized double bedrooms, modern bathroom with shower over the bath and a fully fitted separate kitchen with new appliances.

Streatham Common rail station is virtually on your doorstep, the former tenant joked that you can wait in the apartment for your train to arrive as you can see the platform from both the kitchen and living room windows. Streatham Station and Streatham High Road are both only a short stroll away providing a great choice of shops, bars and restaurants as well as numerous transport links.

Local Authority
Lambeth London Borough Council

Council Tax Band B

EPC Rating D



Contact

02086400146

admin@time2move.com

www.time2move.com

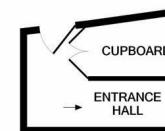

GROUND FLOOR
APPROX. FLOOR
AREA 80 SQ. FT.
(7.4 SQ.M.)

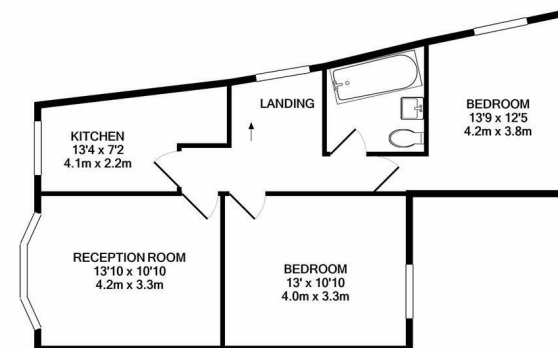

1ST FLOOR
APPROX. FLOOR
AREA 619 SQ. FT.
(57.5 SQ.M.)

EARDLEY ROAD
TOTAL APPROX. FLOOR AREA 699 SQ.FT. (64.9 SQ.M.)

Whilst every attempt has been made to ensure the accuracy of the floor plan contained here, measurements of doors, windows, rooms and any other items are approximate and no responsibility is taken for any error, omission, or mis-statement. This plan is for illustrative purposes only and should be used as such by any prospective purchaser. The services, systems and appliances shown have not been tested and no guarantee as to their operability or efficiency can be given.
Made with Metropix ©2020.