

GROUND FLOOR  
676 sq.ft. (62.8 sq.m.) approx.

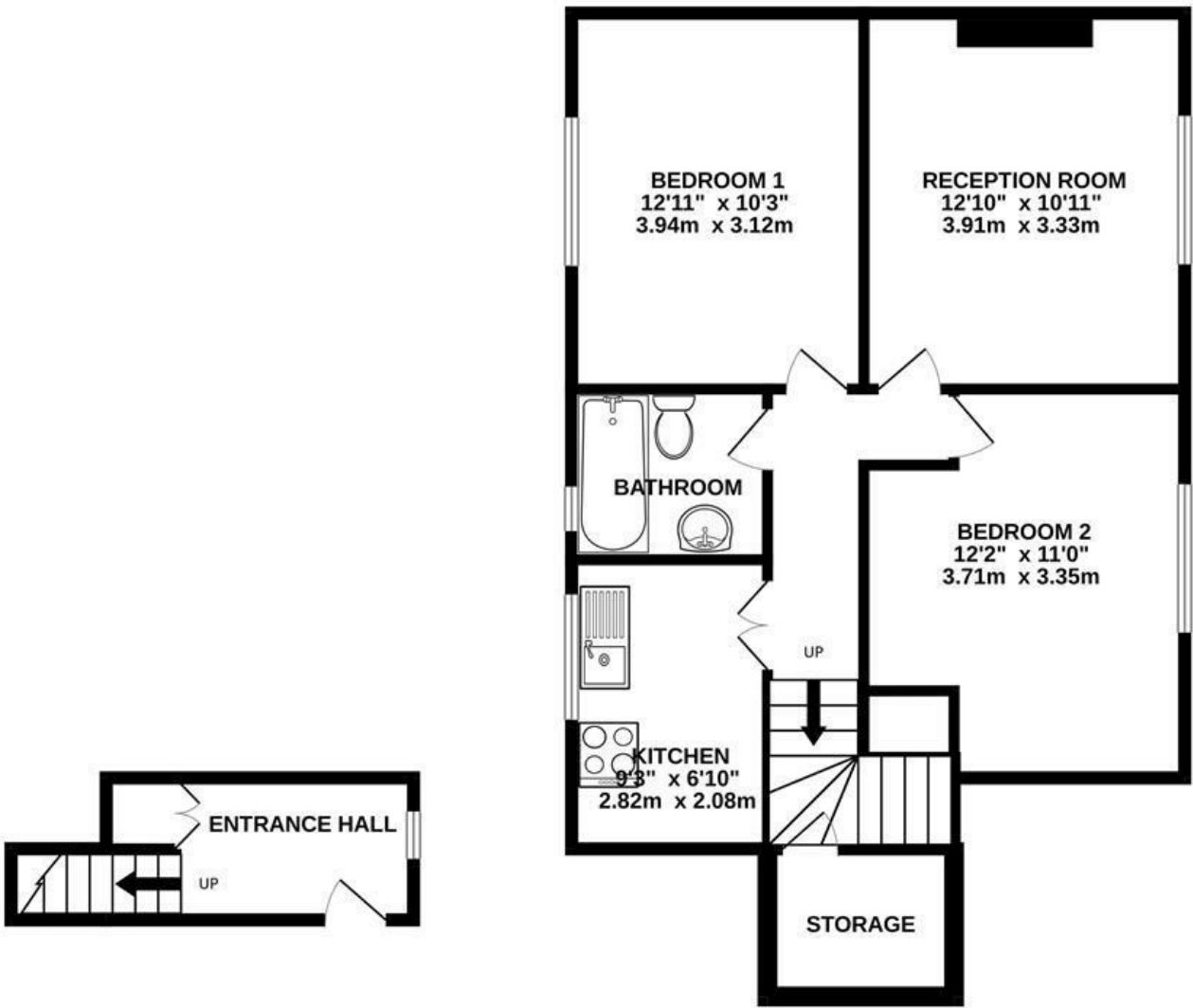

HILL TOP NW11 6EE  
TOTAL FLOOR AREA : 676 sq.ft. (62.8 sq.m.) approx.  
Whilst every attempt has been made to ensure the accuracy of the floorplan contained here, measurements of doors, windows, rooms and any other items are approximate and no responsibility is taken for any error, omission or mis-statement. This plan is for illustrative purposes only and should be used as such by any prospective purchaser. The services, systems and appliances shown have not been tested and no guarantee as to their operability or efficiency can be given.  
Made with Metropix ©2023



Hill Top, London, NW11 6EE

CASH BUYERS ONLY  
A 2 double bedroom 1st floor maisonette WITH OWN PRIVATE PORTION OF GARDEN situated on the first floor with own front door. Extending to 676 Sq Ft - 62.8 Sq M.  
From the front door there is an entry hall with cupboard and stairs leading to the first floor. A reception room with spotlighting, fitted kitchen overlooking the rear, two double bedrooms and a fully tiled bathroom.  
The apartment benefits from a private portion of the garden. The property is set well back from the road behind a shared lawned area. The garden is surrounded by natural hedging borders and a brick wall at the rear.  
Conveniently located close to the East Finchley tube station, The Market Place, which has restaurants and shops, as well as regular bus connections into London, all within walking distance.  
A chain free transaction.

Leasehold

£450,000



