





The logo for 'ms estates' is located in the top right corner. It features the lowercase letters 'ms' in a bold, dark blue font, with a thin red horizontal line underneath. Below this, the word 'estates' is written in a smaller, dark blue font. The entire logo is set against a yellow square background with dark blue L-shaped corner accents.

9 Teversal Avenue, Nottingham, NG7 1PY  
£910 Per Week

 7  2  1  C



# Floor Plan

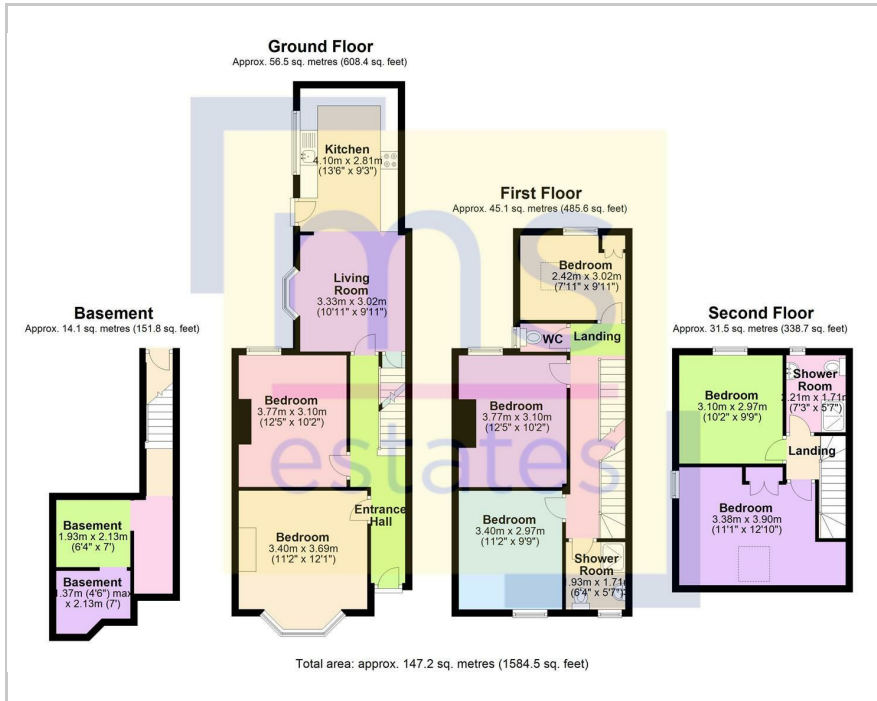

- STUDENT ACCOMMODATION
- 7 double bedrooms
- 2 bathrooms & additional WC
- Open-plan living/kitchen/dining area
- Dishwasher
- Located within the Lenton Triangle
- Close to local amenities
- Very popular location



# Area Map



| Energy Efficiency Rating                    |  | Current                 | Potential |
|---|--|-------------------------|-----------|
| Very energy efficient - lower running costs |  |                         |           |
| (92 plus) A                                 |  |                         |           |
| (81-91) B                                   |  |                         |           |
| (69-80) C                                   |  | 75                      | 79        |
| (55-68) D                                   |  |                         |           |
| (39-54) E                                   |  |                         |           |
| (21-38) F                                   |  |                         |           |
| (1-20) G                                    |  |                         |           |
| Not energy efficient - higher running costs |  |                         |           |
| <b>England &amp; Wales</b>                  |  | EU Directive 2002/91/EC |           |



These particulars, whilst believed to be accurate are set out as a general outline only for guidance and do not constitute any part of an offer or contract. Intending purchasers should not rely on them as statements of representation of fact, but must satisfy themselves by inspection or otherwise as to their accuracy. No person in this firm's employment has the authority to make or give any representation or warranty in respect of the property.