



01932 560777
johnsonandjones.co.uk

**Bridge Wharf
Chertsey, Surrey**

Johnson & Jones

Apartment 7 Agua House Bridge Wharf Chertsey, KT16 8JA

£1,800 PCM

Situated right on the edge of the River Thames in the ever popular Bridge Wharf development, this substantial two bedroom, two bathroom apartment comes with possibly the best views in the entire development!

Offering beautiful undisturbed views of the River the open plan lounge/kitchen/diner is a room that really needs to be seen to be appreciated. With a striking modern kitchen with integrated appliances, a light and airy living space and French doors out on to the balcony, this stylish property is the epitome of modern day living.

Both bedrooms are great sized doubles with a quirky port hole window from bedroom two and fitted wardrobes, an en-suite shower room and a Juliet balcony to the master. The en-suite is fitted with a white three piece suite, chrome fixtures and fittings and contemporary tiling, as is the family bathroom.

Located just a few minutes' walk from Chertsey town centre, we highly encourage an early internal inspection.

Available - Saturday 5th July

Deposit - £2,076

Council Tax - Runnymede - Band E - £2,908.96

EPC - Band C - 79 Rating

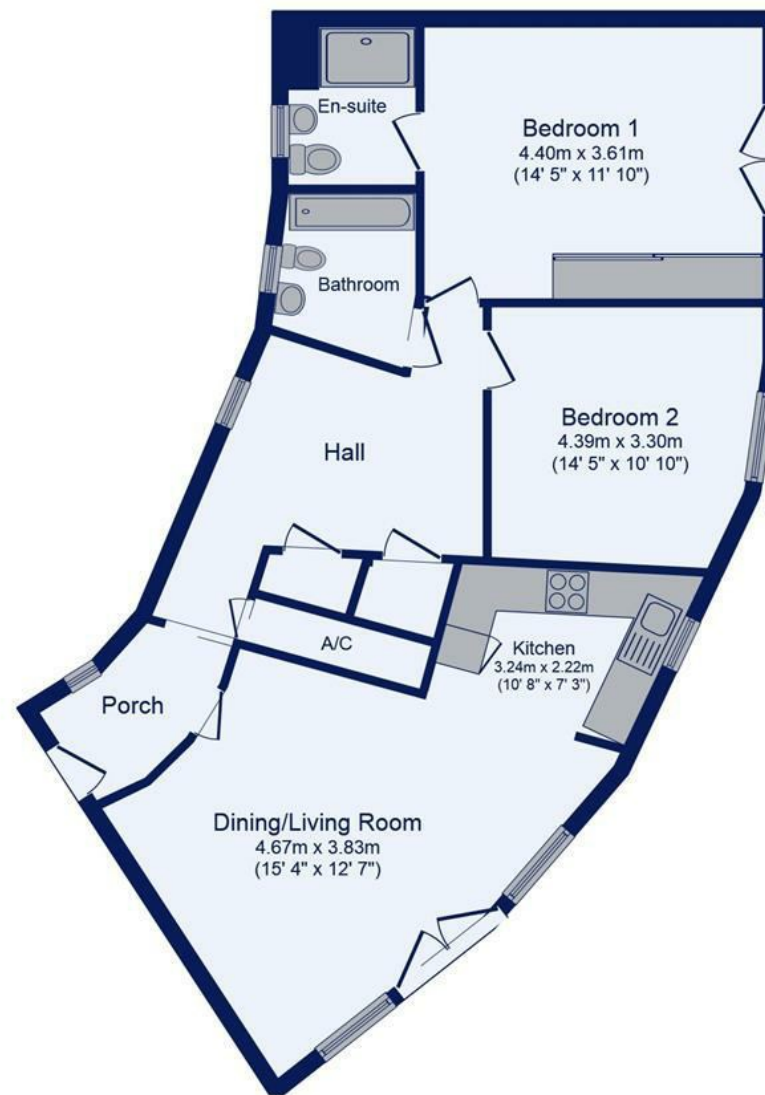

Floor Plan

Floor area 83.0 sq. m. (893 sq. ft.) approx

Total floor area 83.0 sq. m. (893 sq. ft.) approx

This plan is for illustration purposes only and may not be representative of the property.

Plan created for Johnson & Jones Estate Agents.

Produced by www.keyagent.co.uk

Disclaimer: Johnson and Jones Estate Agents cannot verify that the equipment, apparatus, fittings or services within this property are in working order, as they have not tested the relevant items. The buyer is advised to obtain verification from the solicitor dealing with the conveyancing or survey.





10 London Street. Chertsey
Surrey. KT16 8AA

Johnson & Jones