



01932 560777
johnsonandjones.co.uk

Lyne Lane
Chertsey, Surrey

Johnson & Jones

Moorewell House Lyne Lane Chertsey, KT16 0AJ

£2,650 PCM

Built in 1885, we have this gorgeous example of a detached Victorian cottage set within a secluded plot in the highly desired village of Lyne.

Retaining many of its period features, the accommodation is beautifully presented with ample living space. There are two main reception rooms, both of which are brilliant sizes and have french doors leading out to the rear garden, one could also be used as a potential 5th bedroom if required. An additional reception room which would suit perfectly as a dining area is open plan to the kitchen which boasts ample storage space along with a small utility area. There are two double bedrooms on the ground floor, the master also has the added benefit of an en-suite shower room. The family bathroom is also located on the ground floor with a lovely roll top bath and storage space.

The entrance hallway could be used as an additional reception room given its size and also provides access up onto the first floor. There are two almost identical double bedrooms located within the converted loft space allowing for four bedrooms in total.

Externally there are stunning front and rear gardens which are enclosed by bordering hedges along with a gated driveway for multiple vehicles and a pedestrian gate. In the rear garden there is a patio area along with a huge office space which has electric supply and a small kitchen area. The rental figure is inclusive of routine garden maintenance which is arranged by the landlord.

Available - Saturday 21st June 2025

Deposit - £3,057

Council Tax - Runnymede - Band E - £2,908.96

EPC - D Rating - 58

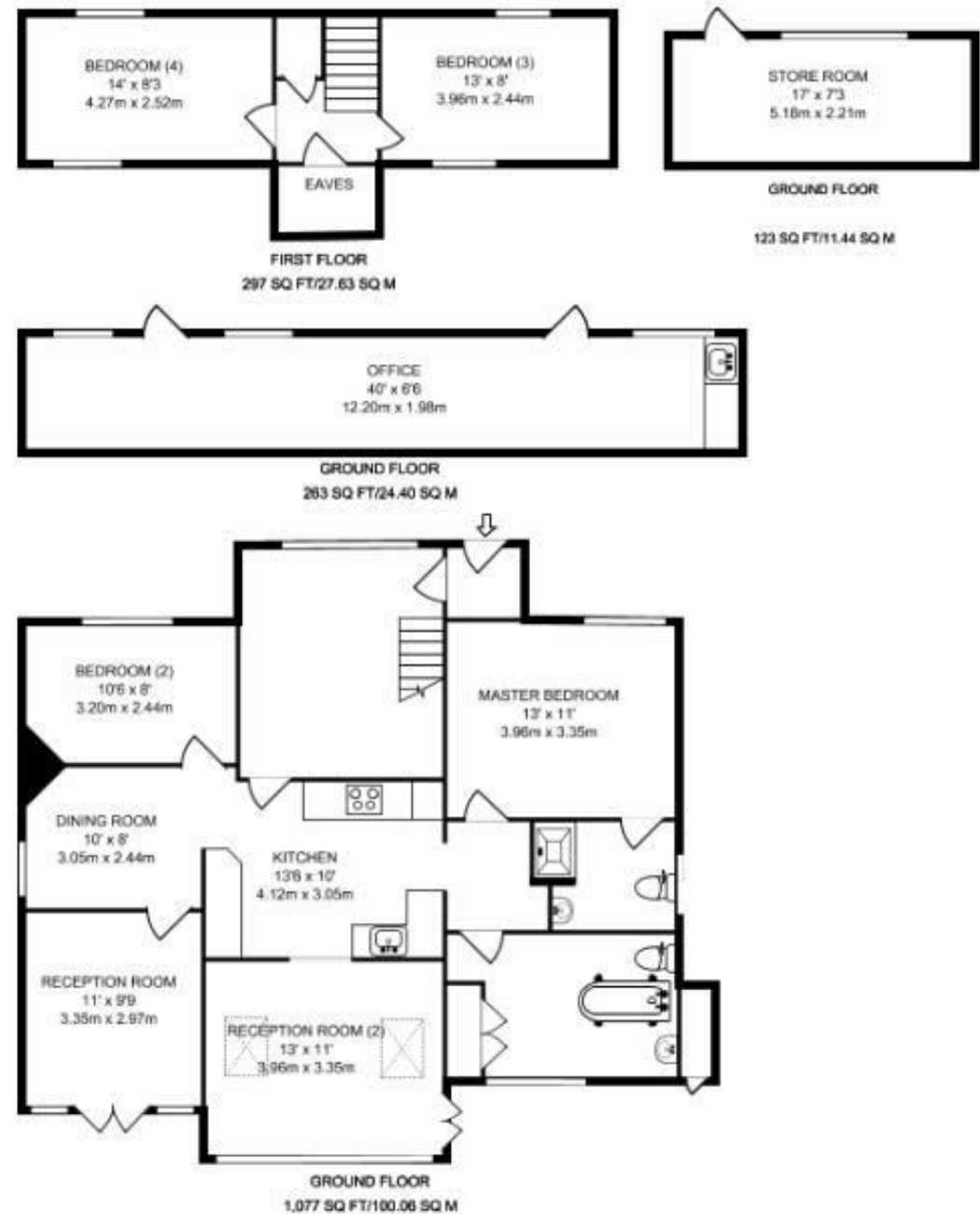

Disclaimer: Johnson and Jones Estate Agents cannot verify that the equipment, apparatus, fittings or services within this property are in working order, as they have not tested the relevant items. The buyer is advised to obtain verification from the solicitor dealing with the conveyancing or survey.





10 London Street. Chertsey
Surrey. KT16 8AA

Johnson & Jones