



Westfield, Harlow, CM18 6AF
Offers Over £330,000



Westfield, Harlow, CM18 6AF

A chain free, three bedroom terraced home in a popular location with double driveway. The property has an entrance hall, lounge with French doors to the garden and a fitted kitchen/breakfast room which has a range of modern fitted wall and base units. The first floor has a sperate bathroom and W.C/shower room and three bedrooms and the garden has lawn and patio areas. Westfield is a popular location within Bush Fair, close by are shops and schooling.

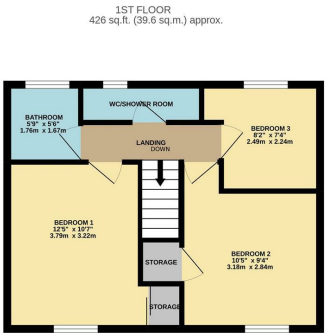
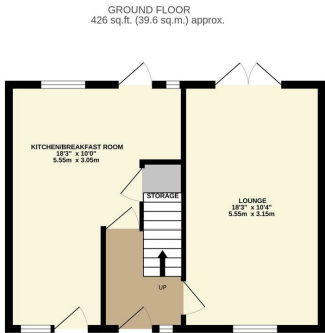

TOTAL FLOOR AREA : 852 sq.ft. (79.2 sq.m.) approx.
While every attempt has been made to ensure the accuracy of the floorplan contained here, measurements of doors, windows, rooms and any other items are approximate and no responsibility is taken for any error, omission or mis-statement. This plan is for illustrative purposes only and should be used as such by any prospective purchaser. The services, systems and appliances shown have not been tested and no guarantee as to their operability or efficiency can be given.
Made with Metropix (2022)

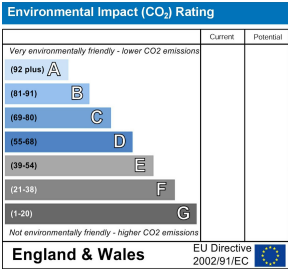
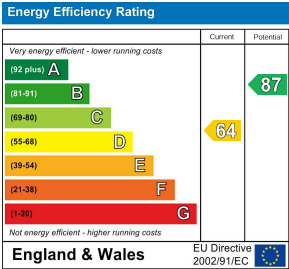

These particulars, whilst believed to be accurate are set out as a general outline only for guidance and do not constitute any part of an offer or contract. Intending purchasers should not rely on them as statements of representation of fact, but must satisfy themselves by inspection or otherwise as to their accuracy. No person in this firms employment has the authority to make or give any representation or warranty in respect of the property.