



## **Alexander Mews, Red Lion Lane, CM17 9BX**

### **£300,000 Freehold**

- Two Double Bedrooms
- Two Parking Spaces
- Two Parking SpacesTwo Receptions
- CHAIN FREE
- End Terrace Chalet Bungalow
- Well Presented
- Gated Development
- EPC Rating: TBC

T: 01279 216 216

E: [info@rjestateagents.co.uk](mailto:info@rjestateagents.co.uk)

Head Office: Bush Fair, Harlow, CM18 6NA W: [www.rjestateagents.co.uk](http://www.rjestateagents.co.uk)

# Alexander Mews, Red Lion Lane, CM17 9BX

**£300,000**

Offered with no onward chain, a spacious two double bedroom end terrace chalet bungalow with allocated parking for two cars. The property comprises an entrance hallway leading to a large lounge, modern kitchen with a range of fitted wall and base units, conservatory, bathroom with a white three piece suite and a ground floor bedroom/dining room. The first floor has a large bedroom with a walk-in storage cupboard and a further bathroom with a white three piece suite. The rear garden is mainly laid to lawn with a patio area, large shed and side access. Alexander Mews is a gated development just off Red Lion Lane in Potter Street with local schools, shops and Harlow Common close by.

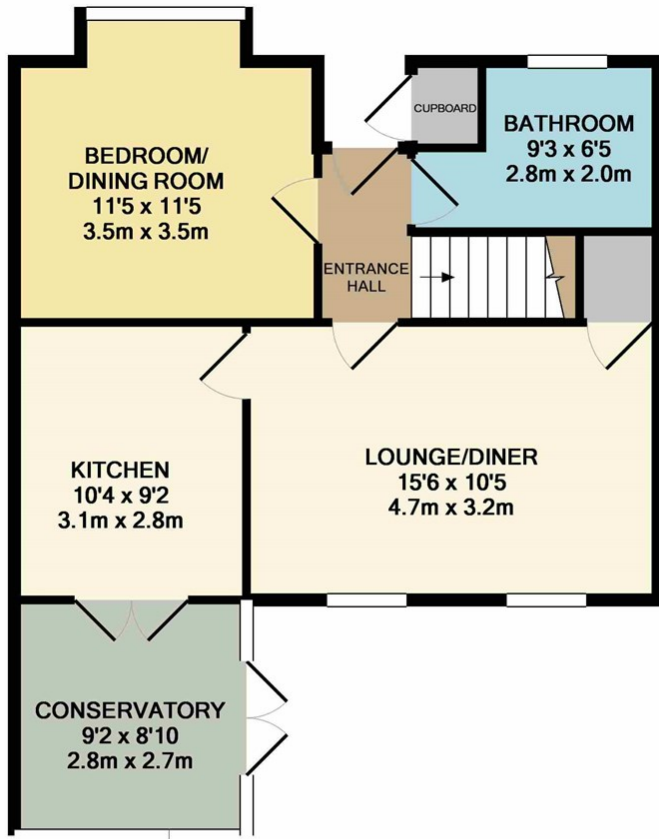

GROUND FLOOR  
APPROX. FLOOR  
AREA 567 SQ.FT.  
(52.7 SQ.M.)

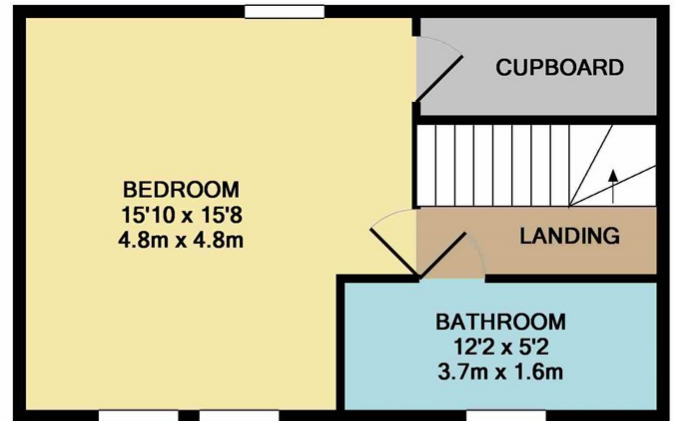

1ST FLOOR  
APPROX. FLOOR  
AREA 369 SQ.FT.  
(34.2 SQ.M.)

1061  
TOTAL APPROX. FLOOR AREA 936 SQ.FT. (86.9 SQ.M.)

Whilst every attempt has been made to ensure the accuracy of the floor plan contained here, measurements of doors, windows, rooms and any other items are approximate and no responsibility is taken for any error, omission, or mis-statement. This plan is for illustrative purposes only and should be used as such by any prospective purchaser. The services, systems and appliances shown have not been tested and no guarantee as to their operability or efficiency can be given  
Made with Metropix ©2018

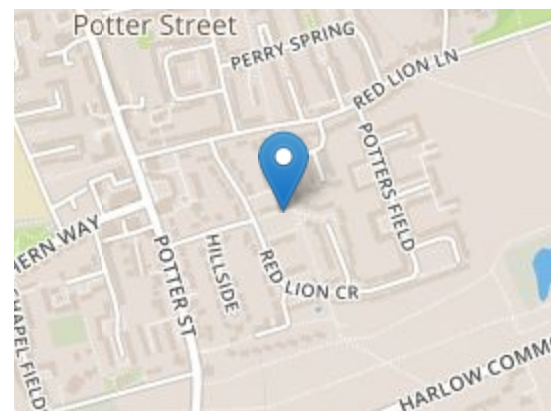

T: 01279 216 216

E: [info@rjestateagents.co.uk](mailto:info@rjestateagents.co.uk)

Head Office: Bush Fair, Harlow, CM18 6NA W: [www.rjestateagents.co.uk](http://www.rjestateagents.co.uk)