



MILE



Hilltop Avenue, London NW10

£368,000 Leasehold

Offering generous proportions throughout, this impressive two-bedroom, two-bathroom apartment combines modern living with comfort and convenience. Thoughtfully designed, the property features a bright and expansive open-plan kitchen and living area, creating the perfect space for both relaxing and entertaining.

Flooded with natural light, the apartment enjoys a wonderful sense of space, with well-balanced accommodation that has been designed to maximise comfort and practicality. Both bedrooms are generously sized, while the two bathrooms provide added convenience for modern lifestyles.

- Two bedrooms
- Two bathrooms
- Spacious
- Plenty of Natural Light
- Off Street Parking
- Private Balcony
- Viewing Recommended
- Open Plan Kitchen - Living area
- Generously proportioned
- Close to shops and transports

13 JAPONICA APARTMENTS, 89 HILLTOP AVENUE, LONDON, NW10 8GN

Approximate Gross Internal Area = 70.0 sq m / 753 sq ft

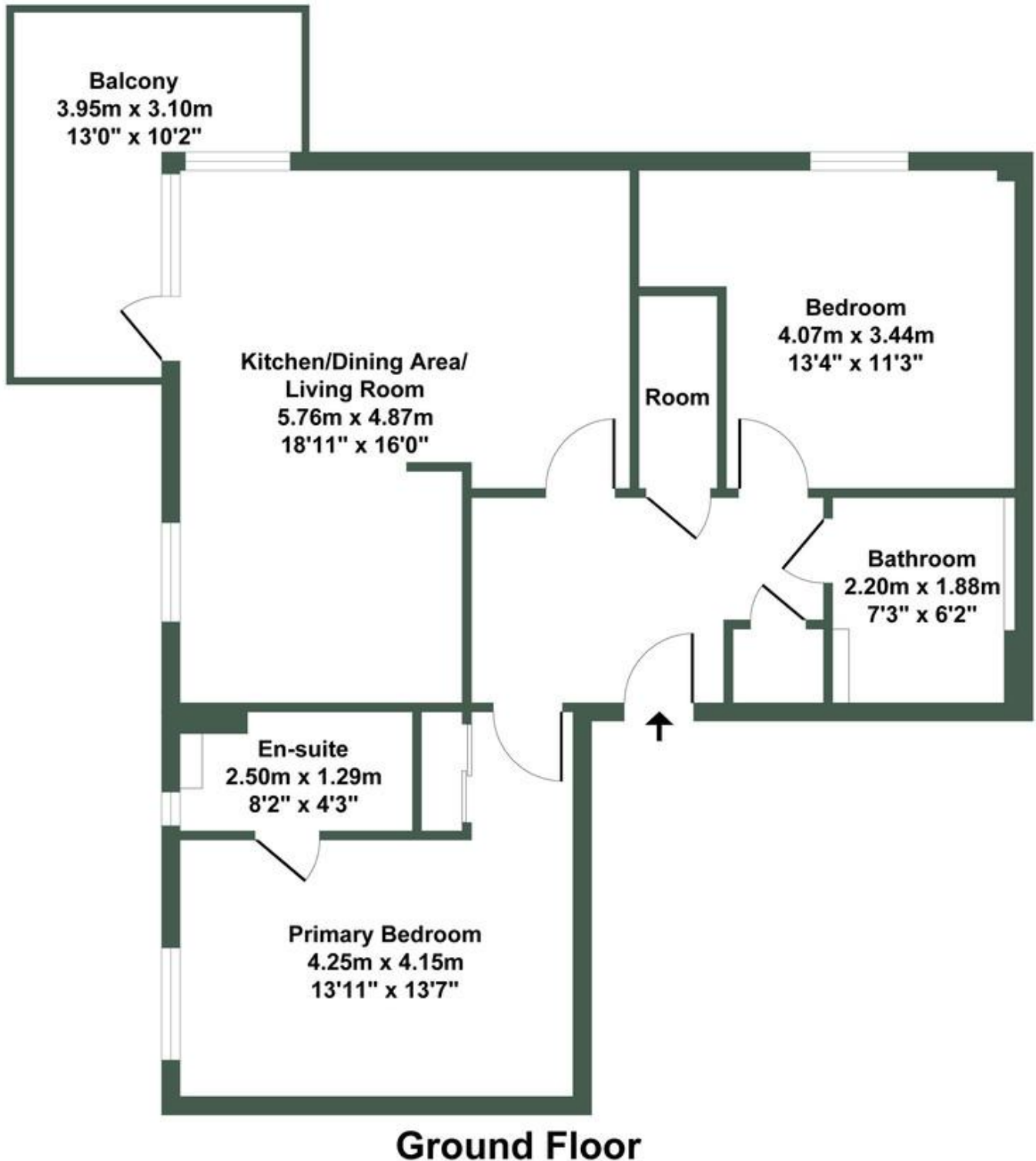

This floor plan is not to scale and measurements and areas are approximate and therefore should be used for illustrative purposes only. maximum widths and

MONEY LAUNDERING REGULATIONS 2003: Intending purchasers will be asked to produce identification documentation at a later stage and we would ask for your co-operation in order that there will be no delay in agreeing the sale.

General: While we endeavour to make our sales particulars fair, accurate and reliable, they are only a general guide to the property and, accordingly, if there is any point which is of particular importance to you, please contact the office and we will be pleased to check the position for you, especially if you are contemplating travelling some distance to view the property.

Measurements: These approximate room sizes are only intended as general guidance. You must verify the dimensions carefully before ordering carpets or any built-in furniture.

Services: Please note we have not tested the services or any of the equipment or appliances in this property, accordingly we strongly advise prospective buyers to commission their own survey or service reports before finalising their offer to purchase.