



Purves Road, Kensal Rise NW10

£1,700 per calendar month

*** SOLE AGENTS ***

mile... is delighted to introduce to the market this fantastic first floor apartment set within this Victorian conversion situated in the heart of Kensal Rise. Offered in excellent condition, this great property comprises of a lovely 16ft reception room with bay windows and a dining area, a fully fitted separate kitchen, two double bedrooms and a modern three piece bathroom. This lovely home benefits from wood flooring in the living-room and main bedroom, original wood sash windows throughout, high ceilings and an abundance of storage space and natural light. Purves Road is an extremely highly sought after residential road and this property is ideally located for Chamberlayne Road and College Road's many restaurants, pubs, independent shops and both Kensal Rise (Overland) and Kensal Green and Queens Park (Bakerloo Line & Overground) stations plus numerous bus routes. Offered on a furnished or unfurnished basis, the property is available from January 2020. EPC Rating: D

- Superb first floor apartment
- Two double bedrooms
- Excellent condition
- Fantastic location
- Available Early February 2020
- Offered furnished or unfurnished
- Separate fully fitted kitchen
- Bright and airy
- Close to shops and transports
- Catchment area for Princess Frederica School

Purves Road London, NW10 5TH, UK
Approximate Gross Internal Area 704 sq ft / 65.43 sq m

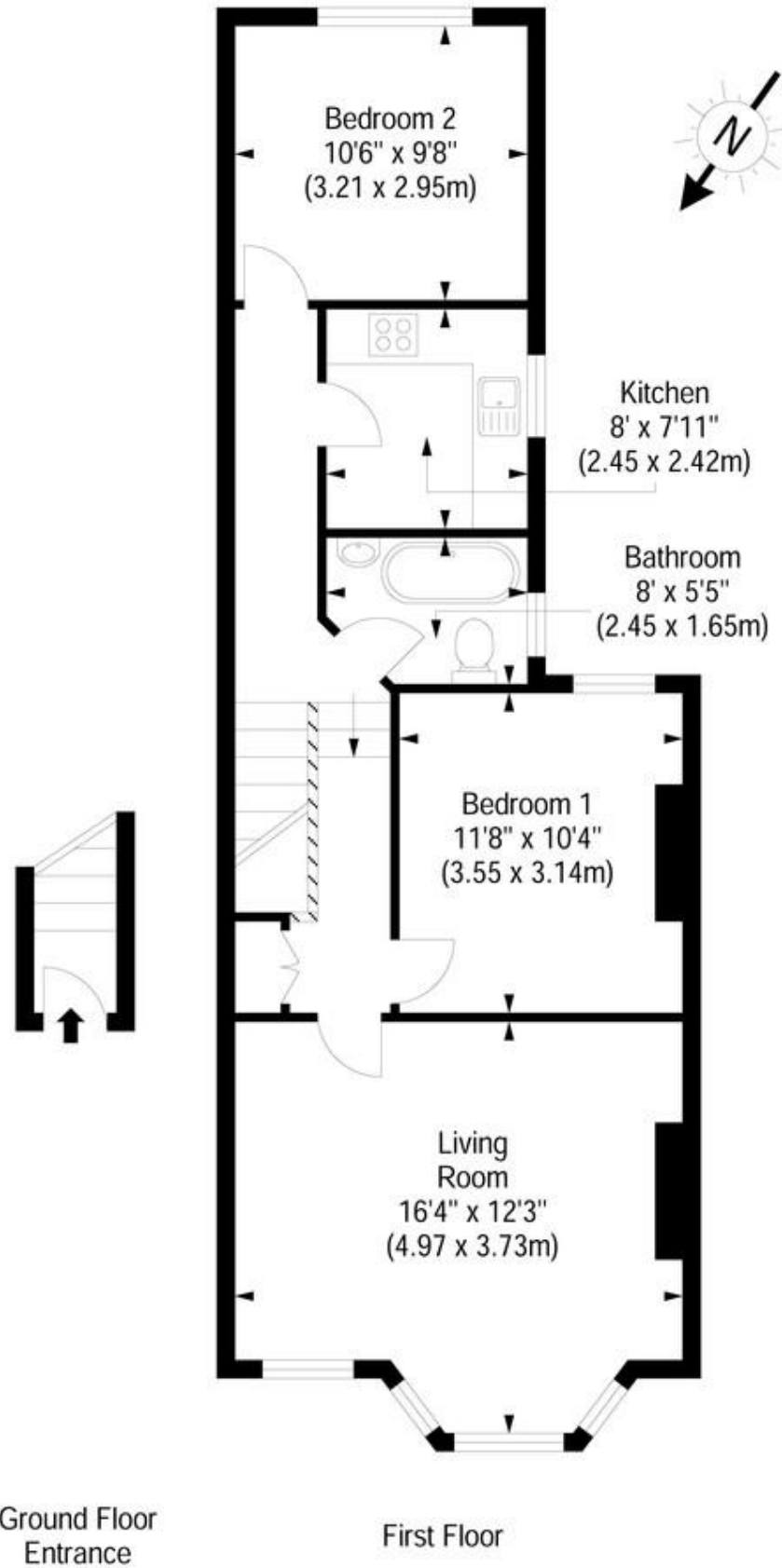

Ref

Copyright THEBLUEPLAN

MONEY LAUNDERING REGULATIONS 2003: Intending purchasers will be asked to produce identification documentation at a later stage and we would ask for your co-operation in order that there will be no delay in agreeing the sale.

General: While we endeavour to make our sales particulars fair, accurate and reliable, they are only a general guide to the property and, accordingly, if there is any point which is of particular importance to you, please contact the office and we will be pleased to check the position for you, especially if you are contemplating travelling some distance to view the property.

Measurements: These approximate room sizes are only intended as general guidance. You must verify the dimensions carefully before ordering carpets or any built-in furniture.

Services: Please note we have not tested the services or any of the equipment or appliances in this property, accordingly we strongly advise prospective buyers to commission their own survey or service reports before finalising their offer to purchase.