



## Clifford Gardens, London NW10

### £600,000 Leasehold

Welcome to Clifford Gardens; great two bedroom first floor apartment in prime Kensal Rise

A spacious and well-located two-bedroom first floor apartment, offering 735 sq ft of comfortable living space in the heart of a popular residential area.

- Period home
- First floor apartment
- Two double bedrooms
- Great Location
- Chain free
- 95 year lease
- 735 sq ft
- Potential to extend (STPP)
- Bright and airy
- Close to shops and transports

# CLIFFORD GARDENS

Approximate Gross Internal Area 735 sq ft / 68.3 sq m

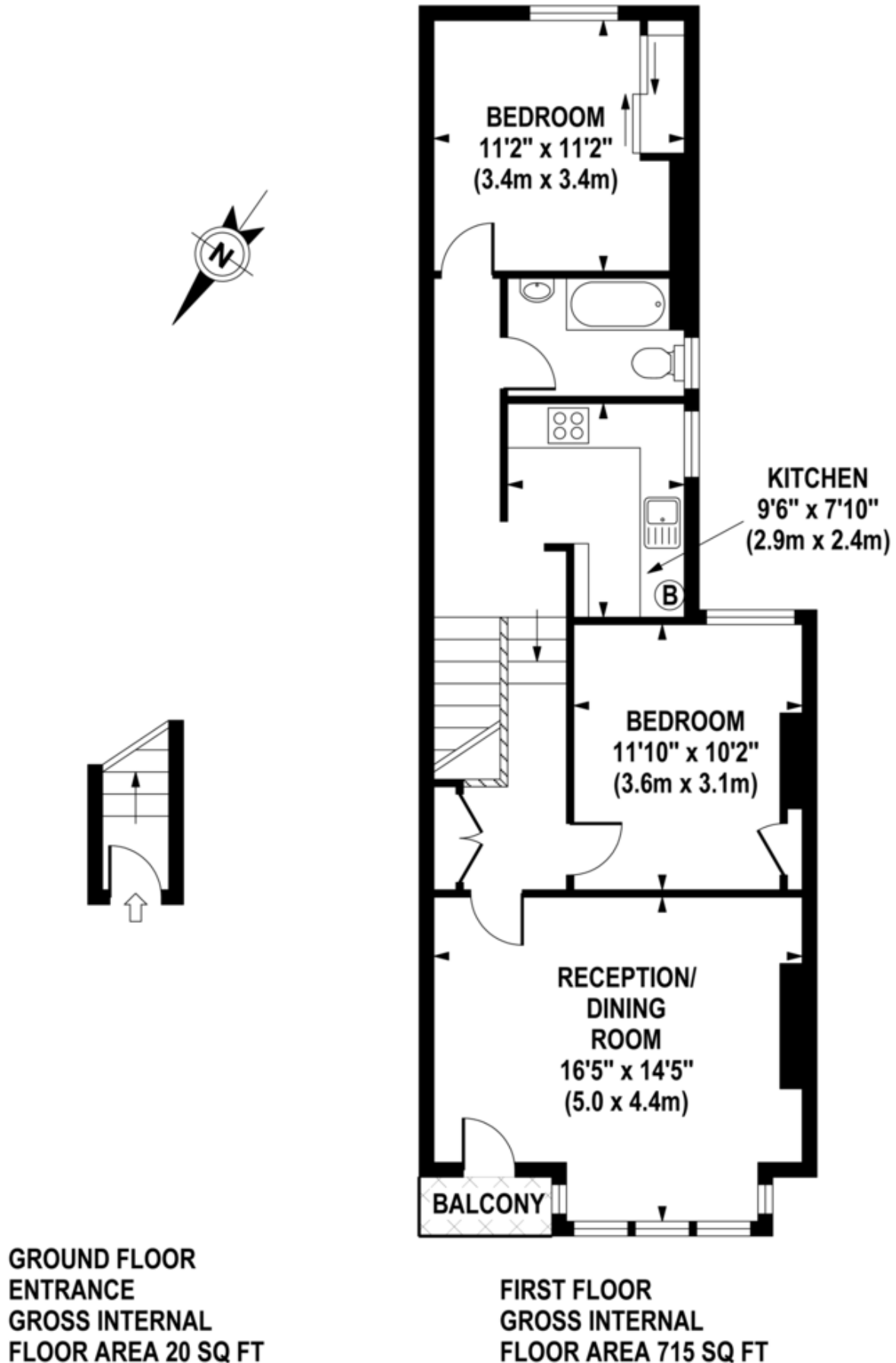

**MONEY LAUNDERING REGULATIONS 2003:** Intending purchasers will be asked to produce identification documentation at a later stage and we would ask for your co-operation in order that there will be no delay in agreeing the sale.

**General:** While we endeavour to make our sales particulars fair, accurate and reliable, they are only a general guide to the property and, accordingly, if there is any point which is of particular importance to you, please contact the office and we will be pleased to check the position for you, especially if you are contemplating travelling some distance to view the property.

**Measurements:** These approximate room sizes are only intended as general guidance. You must verify the dimensions carefully before ordering carpets or any built-in furniture.

**Services:** Please note we have not tested the services or any of the equipment or appliances in this property, accordingly we strongly advise prospective buyers to commission their own survey or service reports before finalising their offer to purchase.