



112 FINCHLEY ROAD
LONDON NW3 5HT
INFO@RHWESTATES.CO.UK
020 7431 7121

WWW.RHWESTATES.CO.UK



MULLION COURT
FINCHLEY ROAD
LONDON
NW3 5HT

A very spacious 2 double bedroom flat within a well-maintained purpose-built block located opposite Finchley Road tube station.

The property was recently refurbished with a kitchen and bathroom and wood flooring throughout and is available furnished or unfurnished.

PRICE: £2,350 PCM

UNFURNISHED



- FEATURES:**
- Passenger Lift
 - Close to public transport
 - Opposite Finchley Road tube station
 - Two double bedrooms
 - Separate kitchen

First Floor

Approx. 78.1 sq. metres (840.3 sq. feet)

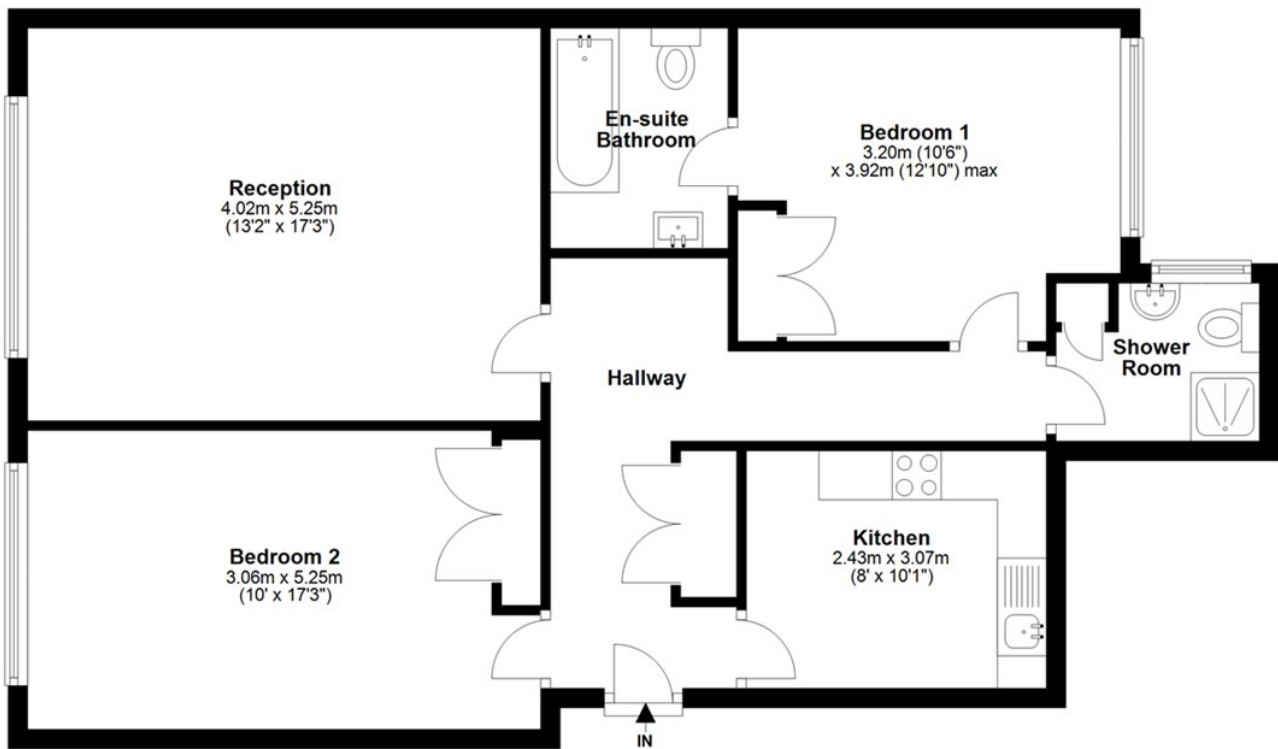
Total area: approx. 78.1 sq. metres (840.3 sq. feet)

Energy Efficiency Rating		
	Current	Potential
Very energy efficient - lower running costs		
(92 plus) A		
(81-91) B		
(69-80) C		
(55-68) D		
(39-54) E		
(21-38) F		
(1-20) G		
Not energy efficient - higher running costs		
England & Wales	EU Directive 2002/91/EC	

IMPORTANT NOTICE

Whilst every attempt has been made to ensure the accuracy of these details and floor plans contained here, measurements of doors, windows and rooms are approximate and no responsibility is taken for any error, omission or mis-statement. These plans and details are for representation only as defined by RICS code of measuring practice and should be used as such by any prospective tenant. Not to scale. Copyright: RHW Estates

