



- Simply stunning
- One double bedroom
- Allocated parking space
- New Lease

Summerville Court, 103 Lansdowne Road, Croydon, Surrey CR0 2BN

Stunning and well maintained throughout is this super one double bedroom Apartment situated in a highly sought after position within walking distance to the ever sought after East Croydon station. The property will come with a brand new extended lease and also has parking. No forward chain! Call us now to view.
EPC Rating C. Tax Band B.

Offers In Region Of £224,995



Property Description

Stunning and well maintained throughout is this super one double bedroom Apartment situated in a highly sought after position within walking distance to the ever sought after East Croydon station. The property will come with a brand new extended lease and also has parking. No forward chain! Call us now to view.

EPC Rating C. Tax Band B.

LEASE New Lease, Length TBC.

SERVICE CHARGE £1000 PA TBC.

GROUND RENT N/A.





Score	Energy rating	Current	Potential
92+	A		
81-91	B		
69-80	C	71 C	76 C
55-68	D		
39-54	E		
21-38	F		
1-20	G		

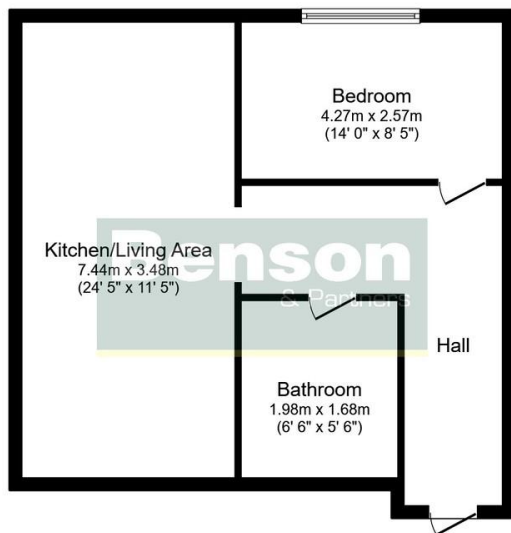

Floor Plan

Total floor area 59.1 sq.m. (637 sq.ft.) approx

This plan is for illustration purposes only and may not be representative of the property. Plan not to scale.

%epcGraph_c_1_334%

49 Lower Addiscombe Road,
Croydon, Surrey, CR0 6PQ

www.bensonpartners.co.uk
02086670121
eastcroydon@bensonpartners.co.uk

Agents Note: Whilst every care has been taken to prepare these sales particulars, they are for guidance purposes only. All measurements are approximate and are for general guidance purposes only and whilst every care has been taken to ensure their accuracy, they should not be relied upon and potential buyers are advised to recheck the measurements.