



- Super investment or home!
- Four bedrooms
- Two bathrooms/wc
- Three w/c's

Rural Way, London, SW16 6PF

SUPER BUY! four bedroom property situated in a cul de sac down a small private access road. Large driveway, largest out of the properties! End of terrace so large side plot. Offered for sale with vacant possession. Four bedrooms with scope for an en-suite. Three w/cs and two bathrooms! Downstairs there is a large kitchen, living room, dining room and conservatory! NO CHAIN!!! keys are held so call us now before its too late!

Offers In Region Of £500,000

Property Description





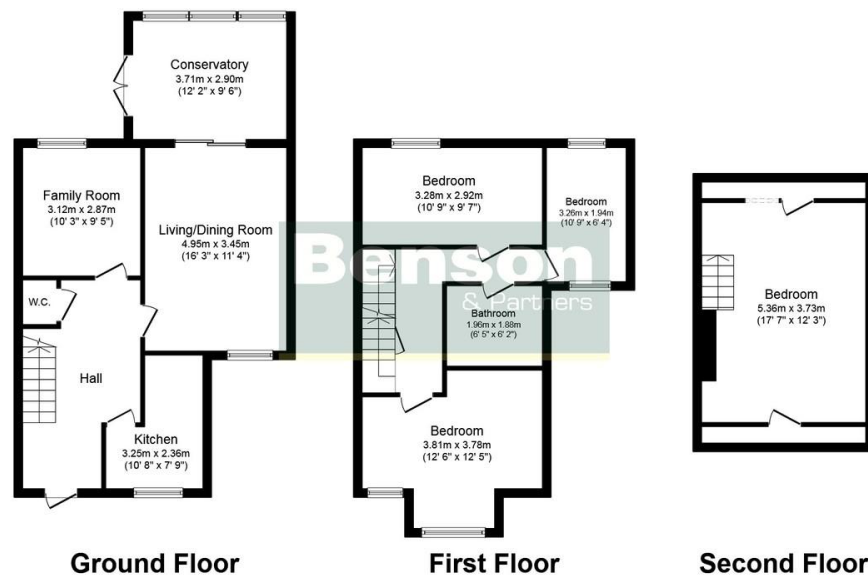

Total floor area 124.9 sq. m. (1,344 sq. ft.) approx

This plan is for illustration purposes only and may not be representative of the property. Plan not to scale.

%epcGraph_c_1_334%

49 Lower Addiscombe Road,
Croydon, Surrey, CR0 6PQ

www.bensonpartners.co.uk
02086670121
eastcroydon@bensonpartners.co.uk

Agents Note: Whilst every care has been taken to prepare these sales particulars, they are for guidance purposes only. All measurements are approximate are for general guidance purposes only and whilst every care has been taken to ensure their accuracy, they should not be relied upon and potential buyers are advised to recheck the measurements