



- Three double bedrooms
- Three reception rooms
- Conservatory
- landscaped garden

Davidson Road, Croydon, CR0 6DE

COMPARE THE SIZE OF THIS TO OTHERS, YOU WILL BE SHOCKED!!!! Three DOUBLE bedrooms being 15'3x12'3, 11'6x9'8, 15'3x10'3 and with an upstairs bathroom! Downstairs are three reception rooms, kitchen and a conservatory! If you want space and location then look no further. Plus there is a fabulous landscaped garden with lighting and a downstairs w/c. Viewings are highly recommended.

£449,995



Property Description

LIVING ROOM 13' 4" x 12' 3" (4.06m x 3.73m)

FAMILY ROOM 15' 3" x 11' 5" (4.65m x 3.48m)

DINING ROOM 11' 6" x 11' 3" (3.51m x 3.43m)

KITCHEN 10' 3" x 9' 5" (3.12m x 2.87m)

CONSERVATORY 10' 4" x 10' 2" (3.15m x 3.1m)

MASTER BEDROOM 15' 3" x 12' 3" (4.65m x 3.73m)

BEDROOM 11' 6" x 9' 8" (3.51m x 2.95m)

BEDROOM 15' 3" x 10' 3" (4.65m x 3.12m)

BATHROOM 8' 8" x 6' 2" (2.64m x 1.88m)





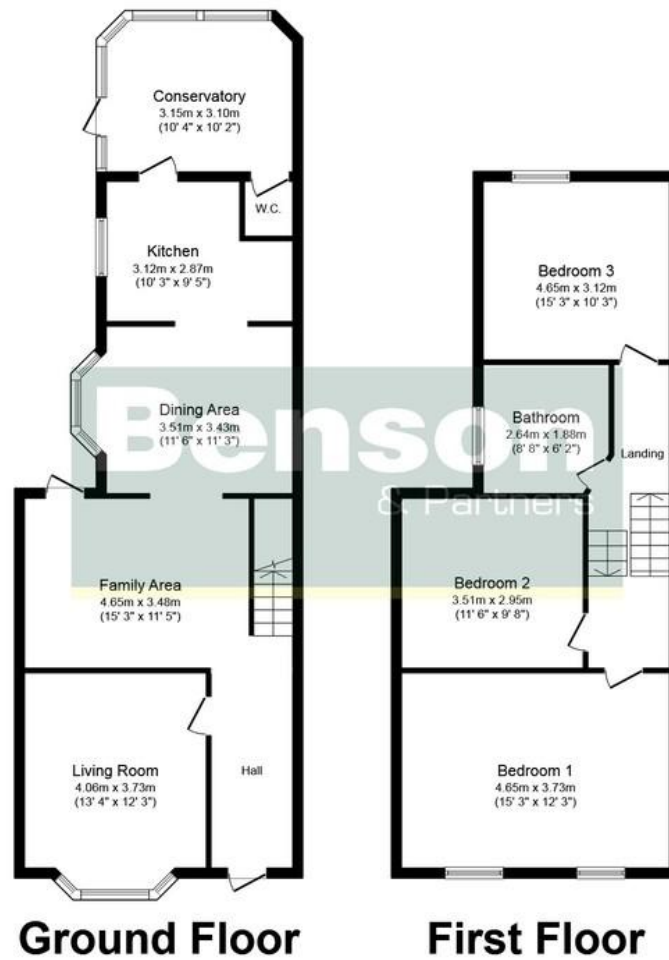

./%

Total floor area 148.0 sq. m. (1,593 sq. ft.) approx

This plan is for illustration purposes only and may not be representative of the property. Plan not to scale.

49 Lower Addiscombe Road,
Croydon, Surrey, CR0 6PQ

www.bensonpartners.co.uk
02086670121
eastcroydon@bensonpartners.co.uk

Agents Note: Whilst every care has been taken to prepare these sales particulars, they are for guidance purposes only. All measurements are approximate and are for general guidance purposes only and whilst every care has been taken to ensure their accuracy, they should not be relied upon and potential buyers are advised to recheck the measurements